

Before Use

1. Remove the protective strips.

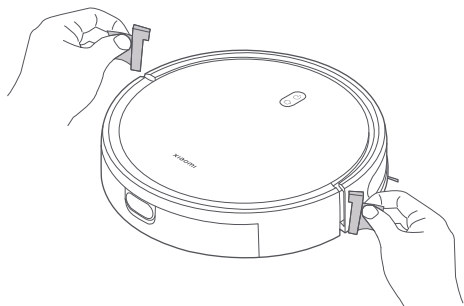

2. Install the side brush.

Take out the side brush, and install it onto the position as indicated in the figure. The side brush is properly installed when you hear a "click".

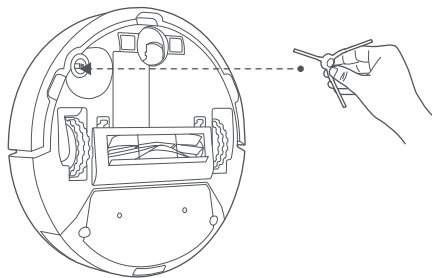

3. Remove the protective film from the charging dock and place the charging dock against a wall. Connect it to the power.

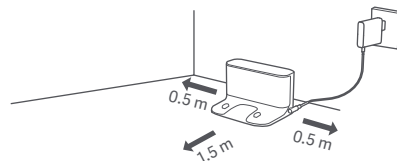

CAUTIONS:

- Do not place the charging dock in an area with direct sunlight.
- Please ensure that no items are placed within 0.5 m on the left and right sides and within 1.5 m in front of the charging dock.

4. Charge the robot vacuum.

Place the robot vacuum on the charging dock to charge.

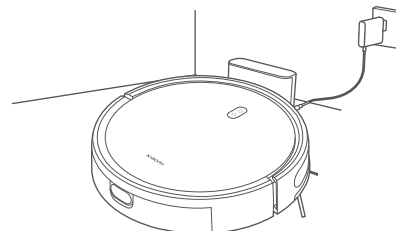

Notes:

- It is recommended to fully charge the robot vacuum before using it for the first time to maintain its optimal battery performance and maximize battery life.
- The robot vacuum will turn on automatically when it is on the charging dock, and cannot be turned off while charging.

Connecting with the Mi Home/Xiaomi Home App

This product works with the Mi Home/Xiaomi Home app*. Use the Mi Home/Xiaomi Home app to control your device, and to interact with other smart home devices.

Scan the QR code to download and install the app. You will be directed to the connection setup page if the app is installed already. Or search for "Mi Home/Xiaomi Home" in the app store to download and install it.



8C8BA4EF



Open the Mi Home/Xiaomi Home app, tap "+" on the upper right, and then follow the instructions to add your device.

* The app is referred to as Xiaomi Home app in Europe (except for Russia). The name of the app displayed on your device should be taken as the default.



Notes:

- The version of the app might have been updated, please follow the instructions based on the current app version.
- If the robot vacuum's QR code cannot be scanned, you can search for its name to add it.
- When connecting the robot vacuum to the Mi Home/Xiaomi Home app using an iOS device, follow the instructions in the app to connect to the robot vacuum's hotspot "xiaomi.vacuum.b112_mibtxxx".

Resetting Wi-Fi

While the robot vacuum is turned on, press and hold the buttons  and  for seven seconds. The Wi-Fi is successfully reset when you hear a voice prompt.

Resetting System

Press and hold the button  for five seconds until you hear a "beep", and then press and hold the button  for five seconds again until you hear the voice prompt. The robot vacuum then restarts, and settings like scheduled cleaning and Wi-Fi are restored to factory default.

Common Issues

The robot vacuum cannot connect to Wi-Fi.

Possible Causes and Solutions

- Check whether the Wi-Fi password is correct.
- The robot vacuum does not support the 5 GHz network frequency band. Please use a 2.4 GHz network.
- The Wi-Fi signal is weak. Make sure the robot vacuum is within the Wi-Fi coverage with a strong signal.
- There is something wrong with the Wi-Fi connection. Reset the Wi-Fi and download the latest version of the Mi Home/Xiaomi Home app, then try reconnecting.

The robot vacuum cannot connect to the "xiaomi.vacuum.b112_mibtxxx" network in the Mi Home/Xiaomi Home app.

Make sure the robot vacuum is within the Wi-Fi coverage with a strong signal, then reset the Wi-Fi of the robot vacuum and reconnect to the network.

How to Use

Start Vacuuming & Mopping

1. Press and hold the release button to remove the 2-in-1 dust compartment with water tank. Open the plug, fill the tank with clean water, and then refasten the plug. Install the 2-in-1 dust compartment with water tank onto the robot vacuum until it firmly clicks into place.

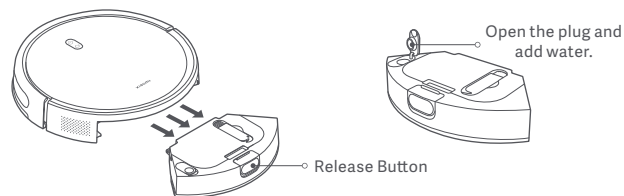

CAUTIONS:

- Please remove the 2-in-1 dust compartment with water tank before adding water. Do not add liquids such as hot water, detergent, or disinfectant to prevent damaging the robot vacuum.
- Due to production testing, the 2-in-1 dust compartment with water tank may have water stains, which is normal.

2. Before using the vacuuming & mopping function, dampen the mop pad and wring it out and then install it onto the mop pad holder. Install the mop pad holder to the 2-in-1 dust compartment with water tank, as illustrated.

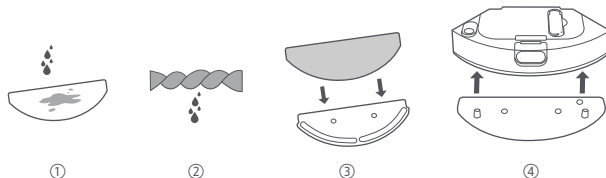

3. Install the 2-in-1 dust compartment with water tank into the robot vacuum. Press the button  to start vacuuming and mopping.

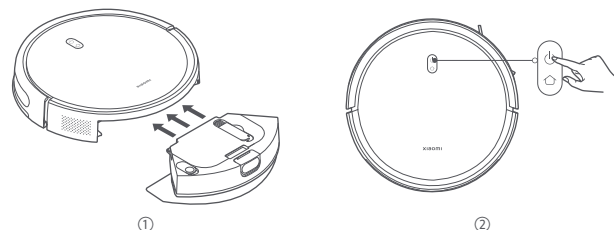

CAUTION: Remove the 2-in-1 dust compartment with water tank and pour out the leftover water in a timely manner after a mopping task has been completed. Then clean and dry the mop pad to prevent odor and mildew.

If only vacuuming function is needed, please remove the mop pad holder.

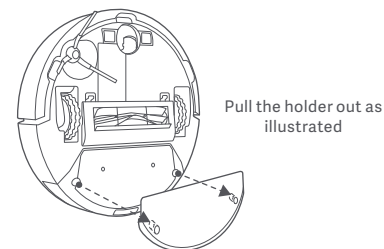

Pausing



When the robot vacuum is running, press any button to pause. Press the button  to resume cleaning.

Note: The robot vacuum will enter sleep mode after being paused or in standby mode for five minutes. Press any button to wake it up.

Adding Water or Cleaning the Mop Pad

When the robot vacuum is working, pause it first then remove the 2-in-1 dust compartment with water tank and clean the mop pad. Then reinstall the 2-in-1 dust compartment with water tank and press the button  to resume the task.

Docking & Charging

When the robot vacuum is working, press the button  to pause the task, and press the button  again to send the robot vacuum to return to the dock to charge.

When the robot vacuum is in standby mode and not connected to the charging dock, press the button  to send the robot vacuum to return to the dock to charge. When a task is complete or the battery is too low, the robot vacuum will automatically return to the dock to charge.

DND Mode

In the do not disturb (DND) mode, the robot vacuum does not perform scheduled cleanups, and the indicator turns off after one minute of charging. The DND mode can be enabled or disabled in the app.

Note: For more functions, please go to the app.

Note: When using the robot vacuum for the first time, it is recommended to follow the robot vacuum and remove any obstacles on the ground. If the robot vacuum may get stuck or scratch the surface of the furniture in some areas, you can set physical barriers to prevent the robot vacuum from entering those areas.

Care & Maintenance

2-in-1 Dust Compartment with Water Tank and Filter

1. Take out the 2-in-1 dust compartment with water tank and open its cover. Remove any debris and clean the 2-in-1 dust compartment with water tank with the cleaning brush.

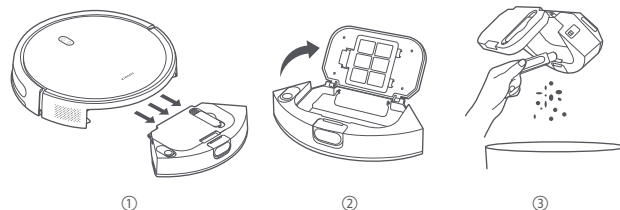

CAUTIONS:

- Do not rinse or soak the 2-in-1 dust compartment with water tank.
- Regularly clean the 2-in-1 dust compartment with water tank to prevent dirt buildup. This will help maintain optimal performance.

2. Remove the filter and clean it with the cleaning brush.

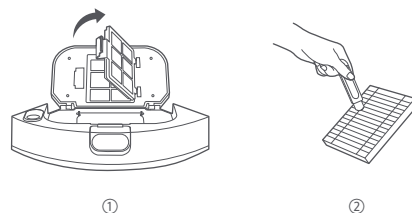

Note: The filter can be rinsed with water. Make sure it is completely dry before reinstalling. Frequent rinses are not recommended.

Mop Pad

Remove the mop pad from the mop pad holder. Wash it and let it air dry.

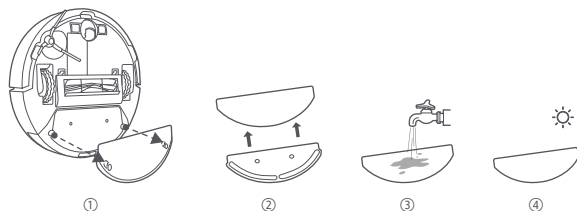

Sensors and Charging Contacts

It is recommended to clean sensors and charging contacts every three months with a soft cloth.

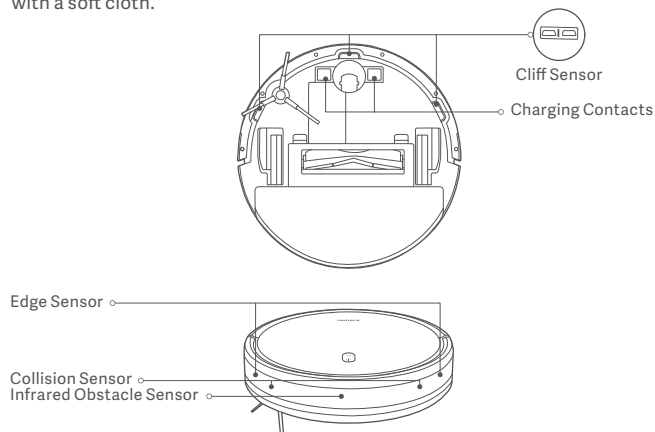

Brush and Side Brush

1. Remove the side brush.
2. Remove the brush cover, take out the brush, and pull out the brush bearing.
3. Use the cleaning brush to clean.

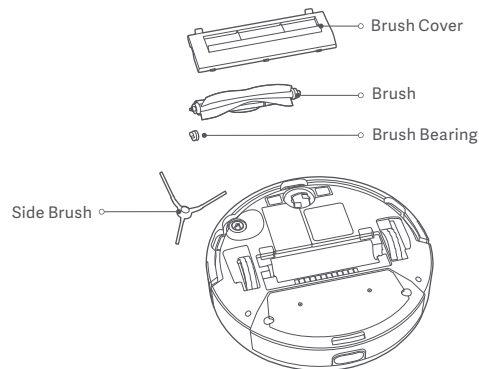

Cleaning the Brush

