

Product Overview

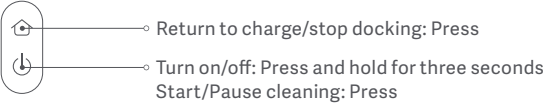
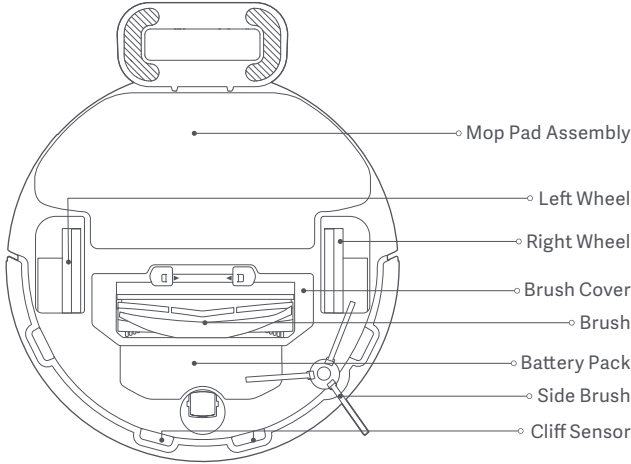
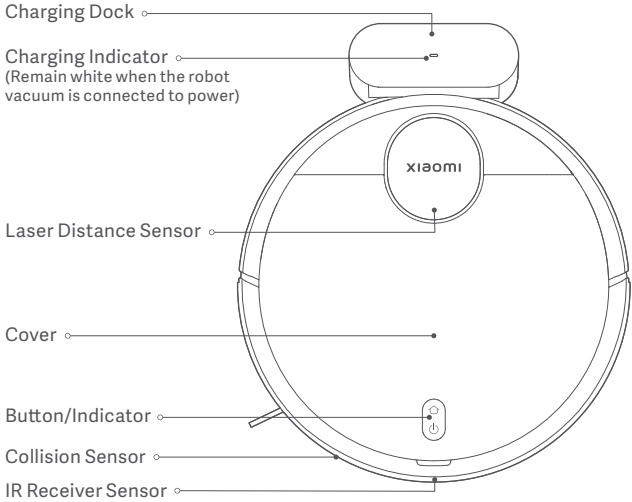

Indicator Status Descriptions

White	Working normally
Slowly blinking white	In charging
Blinking white	Returning to charge/Firmware is upgrading

Yellow	Wi-Fi disconnected
Blinking yellow	Error
Off	Shutdown/In sleep

Before Use

Removal and Installation

- Please remove the protective strips from both sides of the robot vacuum.
- Take out the side brush, and install it onto the position as indicated in the figure. The side brush is properly installed when you hear a "click".

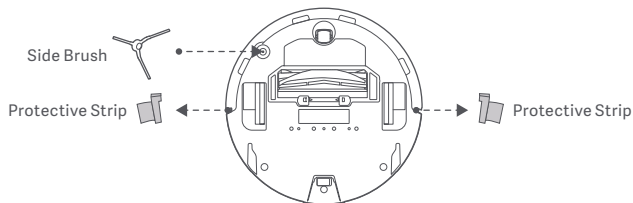

Charging

Remove the protective film from the charging dock. Place the charging dock against a wall and connect it to the power. Then place the robot vacuum onto the charging dock to charge.

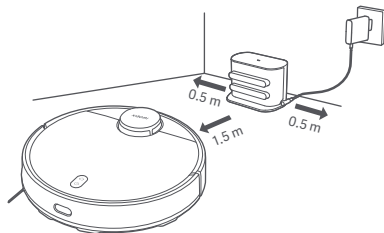

CAUTIONS:

- Do not place the charging dock in an area with direct sunlight.
- Please ensure that no items are placed within 0.5 m on the left and right sides and within 1.5 m in front of the charging dock.
- It is recommended to fully charge the robot vacuum before using it for the first time to maintain its optimal battery performance and maximize battery life.
- The robot vacuum will turn on automatically when it is on the charging dock, and cannot be turned off while charging.

Connecting with Mi Home/Xiaomi Home App

This product works with the Mi Home/Xiaomi Home app*. Use the Mi Home/Xiaomi Home app to control your device, and to interact with other smart home devices.

Scan the QR code to download and install the app. You will be directed to the connection setup page if the app is installed already. Or search "Mi Home/Xiaomi Home" in the app store to download and install it.

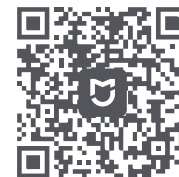

8A347322

Open Mi Home/Xiaomi Home app, tap "+" on the upper right, and then follow prompts to add your device.

* The app is referred to as Xiaomi Home app in Europe (except for Russia). The name of the app displayed on your device should be taken as the default.

Notes:

- The version of the app might have been updated, please follow the instructions based on the current app version.
- If the robot vacuum's QR code cannot be scanned, you can search for its name to add it.
- When connecting the robot vacuum to the Mi Home/Xiaomi Home app using an iOS device, follow the instructions in the app to connect to the robot vacuum's hotspot "ijai-vacuum-v17_miapXXXX".

Resetting Wi-Fi

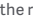
While the robot vacuum is turned on, press and hold the buttons  and  for seven seconds. The Wi-Fi is successfully reset when you hear a voice prompt.

Resetting System

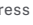
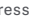
Press and hold the button  for five seconds until you hear a "beep", and then press and hold the button  for five seconds again until you hear the voice prompt. The robot vacuum then restarts, and settings like scheduled cleaning and Wi-Fi are restored to factory default.

How to Use

Start Vacuuming & Mopping

1. Take out the 2-in-1 dust compartment with water tank, open the plug, fill with clean water, and then refasten the plug. Install the 2-in-1 dust compartment with water tank onto the robot vacuum in the direction indicated in the figure, and make sure that the clip is firmly clasped.

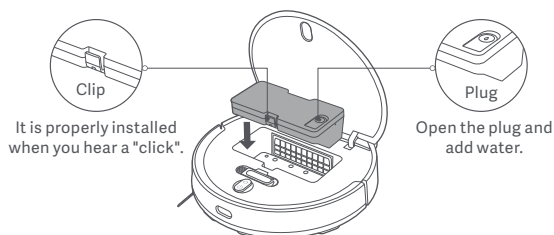

CAUTIONS:

- Please remove the 2-in-1 dust compartment with water tank before adding water. Do not add liquids such as hot water, detergent, or disinfectant to prevent damaging the robot vacuum.
- Due to production testing, the 2-in-1 dust compartment with water tank may have water stains, which is normal.

2. Before using the vacuuming & mopping function, dampen the mop pad and wring it out and then install it onto the mop pad holder. Slide the mop pad holder along the bottom of the robot vacuum horizontally in the direction indicated in the figure until it clicks into place.

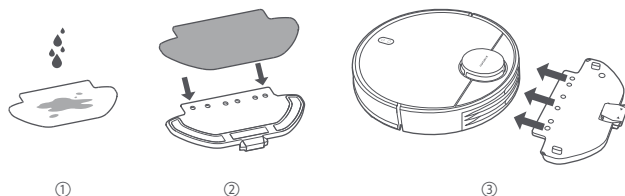

3. Press the button  to start vacuuming and mopping.

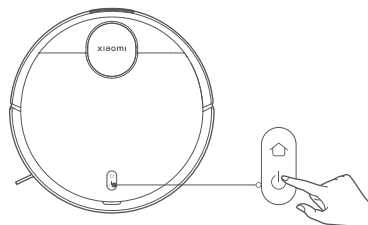

CAUTIONS:

- Remove the 2-in-1 dust compartment with water tank and pour out the leftover water in a timely manner after a mopping task has been completed. Then clean and dry the mop pad to prevent odor and mildew.
- When the robot vacuum is running, please set up virtual walls or restricted areas for carpeted areas in your home to avoid the robot vacuum from becoming entangled in the carpet.

If only vacuuming function is needed, please remove the mop pad holder.

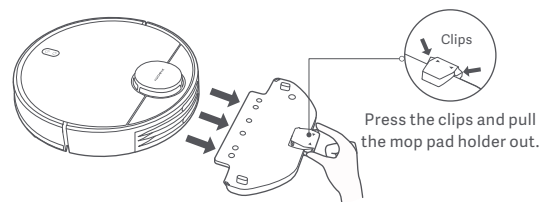

Pausing



When the robot vacuum is running, press any button to pause. Press the button  to resume cleaning.

Note: The robot vacuum will enter sleep mode after being paused or in standby mode for five minutes. Press any button to wake it up.

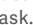
Adding Water or Cleaning the Mop Pad

When the robot vacuum is working, pause it first then remove the 2-in-1 dust compartment with water tank to add water or clean the mop pad. Then reinstall the 2-in-1 dust compartment with water tank and press the button  to resume the task.

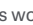
Docking & Charging

When the robot vacuum is working, press the button  to pause the task, and press the button  again to send the robot vacuum to return to the dock to charge.

When the robot vacuum is in standby mode and not connected to the charging dock, press the button  to send the robot vacuum to return to the dock to charge. When a task is complete or the battery is too low, the robot vacuum will automatically return to the dock to charge.

DND mode

In the do not disturb (DND) mode, the robot vacuum does not resume cleanup, perform scheduled cleanups or play voice prompts, and the indicator turns off after one minute of charging. The DND mode can be enabled or disabled in the app.

Note: Please refer to the app for more features, including Clean There, Resume Cleanup, Scheduled Cleanup, and Virtual Walls.

Notes:

- When using the robot vacuum for the first time, please follow the in-app prompts to complete quick map creation. To ensure accurate mapping, it is recommended to follow the robot vacuum and remove any obstacles on the ground when it is creating the map. Make sure the robot vacuum starts from the charging dock.
- If the robot vacuum may get stuck or scratch the surface of the furniture in some areas, you can set restricted areas in the app to prevent the robot vacuum from entering those areas.

Care & Maintenance

Brush and Side Brush

- Remove the side brush.
- Press and hold the clips to remove the brush cover, then remove the brush, and pull out the brush bearing.
- Use the cleaning brush to clean.

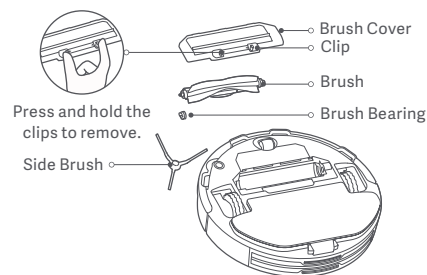

Cleaning the Brush

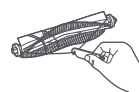

Cut the hair

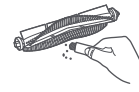

Remove dirt and debris

Notes:

- For cleaning and maintaining the 2-in-1 dust compartment with water tank & mop pad assembly, please refer to the labels on the tank and mop pad holder.
- It is recommended to clean the cliff sensor every three months with a soft cloth.
- Please refer to the table for accessory replacements to ensure the optimal cleaning effect.

Components	Maintenance Frequency	Replacement Frequency
Side brush	Every two weeks	Every 3–6 months
Brush	Weekly	Every 6–12 months
Filter	Weekly	Every 3–6 months
Brush cover	/	Every 3–6 months (or upon worn)
Mop pad	After each use	Every 3–6 months (or upon worn)