



Joyful Kids · Joyful Trip



www.jovikids.com



[jovikids_global](https://www.instagram.com/jovikids_global)



service@jovikids.com

Model WD034

All rights reserved @2024 JOVIKIDS. JOVIKIDS and all associated logos are trademarks.
All product specifications are correct at time of print.
JOVIKIDS reserves the right to change anything at any time without prior notice.
Color representation is as close as processes allow.



USER MANUAL

RANGER i-Size

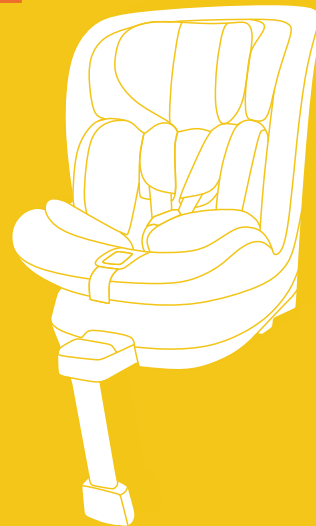

Approx.
0Y-12Y

40-150cm





EN Scan for user manual

DE Scan für Benutzerhandbuch

FR Scannez pour le manuel d'utilisation

IT Scansiona per il manuale utente

ES Escanear para el manual del usuario

JP QRコードをスキャンして説明書を表示します

AR يحاشر ليل ايلحلح لسم

RU сканируйте для руководства пользователя

•

•

•

CONTENTS

Content	1
Introduction	2
Important Information	3-4
Know Your Car Seat	5-6
Car Seat Version	7
Suitability	8
Use in the Vehicle	9-10
Securing Your Baby	11-13
Using Baby Insert	11
Harness & Headrest Adjustment	12
Side Impact Protection (Optional)	12
To Change the Reclining Positions	13
Installation in the Vehicle	14-29
Opening Support Leg/ Retracting Support Leg	14
Installation Instruction for Stature 40-105cm, Rearward Facing, ISOFIX Attachment + Support Leg + Harness	15-18
Installation Instruction for Stature 76-105cm, Forward Facing, ISOFIX Attachment + Support Leg + Harness	19-22
Installation Instruction for stature 100-150cm, Forward Facing, ISOFIX Attachment + 3-Point-Belt	23-24
Installation Instruction for stature 100-150cm, Forward Facing, 3-Point-Belt	25-26
Care Instructions	27-28
Cleaning	27
Security Checking	27
Warranty	28

INTRODUCTION

Dear Parents,

Thank you very much for purchasing our product.

The functions and design of this car seat offer safety and comfort when your child is in this child restraint.

In order to use safely, please adjust the child restraint till it is suitable for your child .

Please take care to use this car seat and read the instruction manual carefully.

Research shows that a high number of car safety seats are incorrectly installed.

Therefore, please take the time to read through the instruction manual carefully.

Our product offers maximum safety only when it is used in accordance with the instructions.

Continuous research by our development team, user tests and consumer reactions ensure that we are kept fully up to date in the field of child safety.

Therefore, if you have any questions concerning use of our product, please do not hesitate to contact us.

You can see our contact information on our website.



IMPORTANT INFORMATION

WARNING

- Read this instruction manual carefully.
- The correct fitting of the ISOFIX and support leg anchoring systems is of vital importance for the safety of your child.
- For the future using of the seat, it is important that you keep the instruction manual carefully. There is an instruction storage on the back of the seat where the instruction can be retained with the child restraint.
- Never leave your child unattended in the car.
- Do not use a child safety seat if the vehicle seat is equipped with a front airbag. This can be dangerous. This does not apply to side airbags.

■ IMPORTANT-DO NOT USE THE SEAT IN FORWARD FACING BEFORE THE CHILD'S AGE EXCEEDS 15 MONTHS.

- Before using our product, please read the instruction manual carefully, the product is a safety product and is only safe when used in accordance with the instruction manual.
- The product must only be used on a forward facing seat that is fitted with the ISOFIX and support leg anchoring systems.
- The product may be used on either the front or the back seat. However, we recommend that it is fitted on the back seat.
- The product has been approved according to the strictest European safety standards(R129/03)and is for stature 40-105cm(child mass limit 18kg) rearward facing, ISOFIX+ support leg+ harness and is for stature 76-105cm(child mass limit 18kg), forward facing, ISOFIX+ support leg+ harness and is for stature 100-150cm, forward facing, ISOFIX attachment + vehicle 3 point belt and is for 100-150cm, forward facing vehicle 3 point belt.
- After an accident the seat may become unsafe due to damage that is not be noticeable immediately. It should therefore be replaced.
- The safety of the seat can only be guaranteed by the manufacturer if it is issued by the original owner.
- We strongly advise that you do not to use a second-hand car seat, because you are not know if it is in good condition.
- The harness pads and crotch pad are important for the safety of your child therefore use them for stature 40-105cm.
- Ensure that all luggage and objects likely to cause injury in the event of an accident are properly secured.
- Do not use this child seat in passenger seats that are equipped with airbags.

- It is recommended that the car seat should not be used more than 5 years from the date of production. The performance of the product may deteriorate, such as the plastic ageing, which may not be visible.
- The baby car seat must not be used without the cover. Please use an original cover, as the cover contributes to the safety of the seat.
- The seat must be secured with a seat belt or ISOFIX and support leg, even when it not on use. An unsecured seat may injure other passengers in the care in an emergency stop.
- The rigid and plastic parts of a child restraint must be positioned and installed so they do not become trapped by a movable seat or a vehicle door during everyday use.
- Ensure that the seat is not damaged by heavy luggage, adjustable seats or slamming the car door etc.
- No alterations may be made to the product as this could affect part or the overall safety of the seat.
- In hot weather the plastic and metal parts of the product will become hot. You should cover the seat when the car is parked under the sun.
- In order to prevent damage to the cover, do not remove the product's logo.
- Before purchasing, please check that the seat is properly secured in your car.
- Take a short break during long journey. So that your child has some time for the relaxation.
- Set a good example yourself and always wear your seat belts.
- Tell your child that they should never play with the harness buckle.
- Any straps holding the restraint to the vehicle should be tight, any straps restraining the child should be adjusted to the child's body, and straps should not be twisted.
- Ensure that any lap strap is worn low down, so that the pelvis is firmly engaged.
- This product can not be used any more when it has been subject to violent stresses in an accident.
- Children can not be left in the product unattended.

Questions:

Contact your supplier or retailer if you wish to make a warranty claim or have any other questions.

Your car seat can be fixed safely on almost all car seats. However, the belts of some seats are fixed so that proper installation is not possible, in that case, try another seat.

KNOW YOUR CAR SEAT

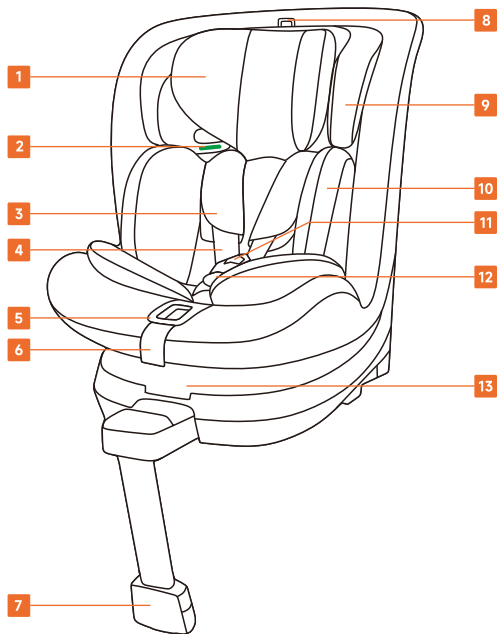

- | | |
|-----------------------------|----------------------------|
| 1. Headrest | 8. Headrest Adjusting Loop |
| 2. Headrest Belt Guide | 9. Headrest |
| 3. Shoulder Belt Pads | 10. Inner Cushion |
| 4. Shoulder Strap | 11. Harness Buckle |
| 5. Harness Adjusting Button | 12. Buckle Pad |
| 6. Harness Adjusting Strap | 13. Rotation Button |
| 7. Support Leg Indicator | |

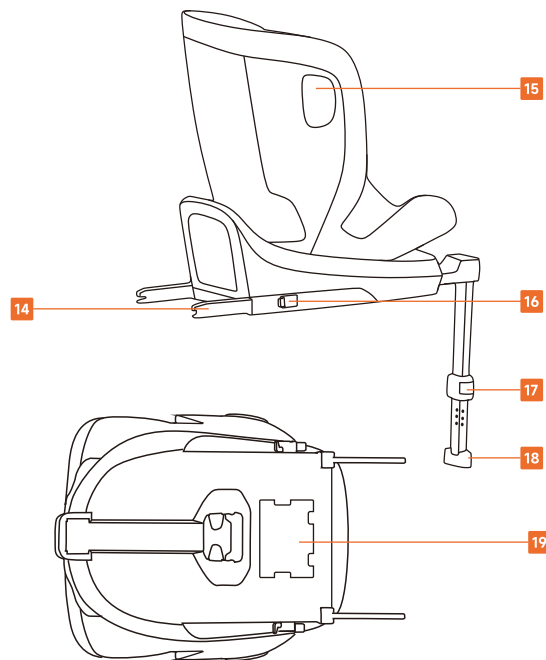

- 14. ISOFIX Connector
- 15. Side Protection
- 16. ISOFIX Release Button
- 17. Support Leg Adjusting Button
- 18. Support Leg Block
- 19. Instruction Storage

ISOFIX Guide



Insert the ISOFIX Guides onto the car's anchors to attach the child seat securely

CAR SEAT VERSION

1. Product Description:

Type	Stature	Facing Direction	Installation	Approval Type
WD034	40cm-105cm	Rearward	ISOFIX + Top Tether +Harness	i-Size
	76-105cm	Forward	ISOFIX + Support Leg + Harness	i-Size
	100cm-150cm	Forward	Vehicle 3-Point-Belt +SOFIX Attachment Vehicle 3-Point-Belt	i-Size Booster Seat

SUITABILITY

2.Certification



...as a child safety seat installed in a vehicle

Child Safety Seat	Tested and certified according to ECE R129			
	Stature	Rearward	Forward	Forward
RANGER		40-105cm	76-105cm	100-150cm

ECE= European Standard for Safety Equipment

The child safety seat has been designed, tested and certified in accordance with the requirements of the European Standard for Child Safety Equipment (ECE R129/03).

The seal of approval E (in a circle) and the approval number are located on the approval label (sticker on the child safety seat).

This approval will be invalidated if you make any modifications to the child safety seat. Only the manufacturer is permitted to make modifications to the child safety seat.

USE IN THE VEHICLE

3. Use in The Vehicle

WARNING



Never use this child restraint system in seating positions where an active airbag is installed. An active frontal airbag may cause death or serious injury of your child in an accident. Please read the instructions carefully and keep them in the future. There is an instructions compartment in the back of the child car seat for storage of the instructions manual.



You Can Use Your Child Car Seat as Follows

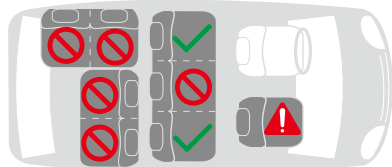

On front passenger seat



Only if there's no airbag or it is turned off! There must be an ISOFIX system. (Slide the seat back and refer to vehicle instructions).

WARNING

Never use the child car seat without its fabric cover. The fabric cover should not be replaced with any other than the ones recommended by manufacturer. The fabric cover will affect the integral performance of the baby/child restraint system.

Never try any other force points than the indicated, the main force points of this product are the ISOFIX adapter and the support leg.

SECURING YOUR BABY

4.1 Using Baby Insert

CAUTION

If your baby's stature is less than 75cm, Please install the inner cushion on child seat. If your baby's stature is between 75cm and 150cm, Please take out the inner cushion from the child seat.

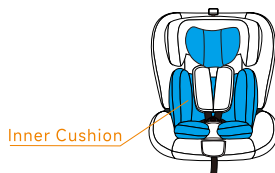

- Always secure your baby in the car seat with the harness or seat belts.
- Never leave your baby unattended in the car seat when placing it on elevated surfaces(e.g., a table, nappy changing unit, etc.).
- Never allow the strap end to become caught in moving parts (e.g., automatic doors, escalators, etc.).
- Caution! The plastic parts of the car seat can heat up in the sun, posing a risk of burns to your baby.
- Protect your baby and the car seat from intense sunlight (e.g., by covering the seat with a light cloth).
- Take your baby out of the car seat as often as possible to relieve pressure on their spine. We recommend taking frequent breaks during long journeys. Additionally, please avoid leaving your baby in the car seat for too long.

4.2 Harness System & Headrest Adjustment

Loosen the shoulder straps by pressing the harness adjusting button and pull the shoulder straps as far forward as possible.

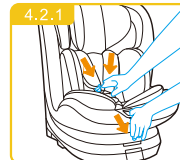

Pull the headrest adjusting loop to adjust the headrest upwards, pull the headrest adjusting loop and push the headrest back to slide the headrest downwards.

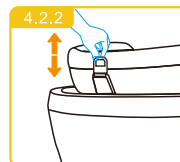

- Before installing the baby car seat into your vehicle, please move the headrest to the correct height for your baby/child and check that it is properly engaged by lightly sliding the headrest down.
- There are 9 adjustable headrest positions. Please adjust the headrest height to close to your baby/child shoulder position, if at the middle of two positions, please use the higher position.

4.3 Side Impact Protection(Optional)

Install the side protector on the side protection, slide forward until you hear a "click" sound (Pic.4.3.1).
Note: when side impact protection is used, it may not fit all vehicles.

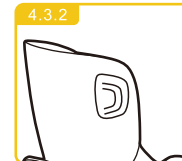
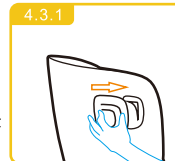

SECURING YOUR BABY

4.4 To Change the Reclining Positions

There are 5 recline positions of this product. To change the position, grasp the lever at the front of the seat, move the seat into the desired position until you hear an audible "click" sound.

Rearward Facing Adjustment

- For use with children between 40-105cm stature.
- The rearward mounting seat angle is adjustable in 5 gears.



Forward Facing Adjustment

- The reclining positions can be adjusted for forward facing use for children with a stature of 76-105 cm.
- The reclining position 4 and 5 do not apply for all vehicles.

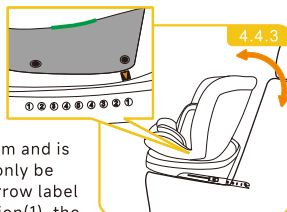

If the child is between 100 cm and 150 cm and is secured by a 3 point harness, it should only be used in an upright position. When the arrow label is aligned with the mounting label position(1), the seat is in an upright position.

INSTALLATION IN THE VEHICLE

5. Opening Support Leg

First, remove the supporting leg from the bottom of the seat. When the support leg is rotated outward to 45°, the supporting leg assembly can be pulled out outward.



CAUTION

The seat can only be rotated when the support leg assembly is extended.

5.0.1 Retracting Support Leg

Rotate the support leg backward to 45° and push the support leg assembly inward until it is fully in place. Finally, tuck the support leg into the slot at the bottom of the seat.

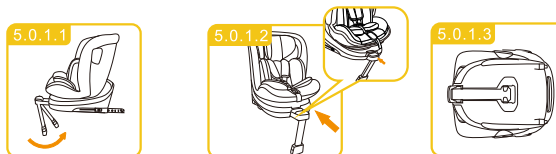

INSTALLATION IN THE VEHICLE

5.1 Installation Instruction for Stature 40-105cm Rearward Facing, ISOFIX + Support Leg + Harness

Press the ISOFIX release button to extend the ISOFIX connectors fully.

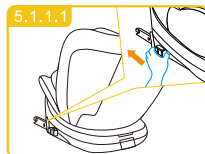

Caution: Only proceed to the next step once the ISOFIX has been fully extended and the red marks are visible.

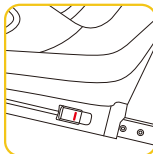

Insert the ISOFIX connectors directly into the anchorages until you hear a distinct "click" sound.

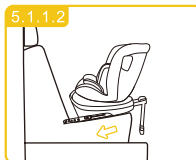

Grasp the main body of the seat to check its stability. Observe the ISOFIX red/green indicator while doing so. If the seat is unstable or the ISOFIX connectors come loose please repeat the steps and reinstall.

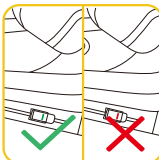

Squeeze the support leg adjusting button, pull out the support leg until it rests firmly on the floor. Observe the ISOFIX red/green indicator to confirm the installation status.

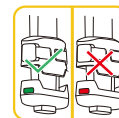
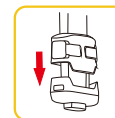

Rotate the seat to the sideward facing position by pressing the rotating button. This will allow easy access for placing the child into the car seat.

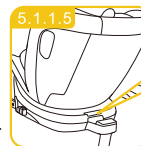

CAUTION

Please ensure that the lap strap is worn low down, so that the pelvis is firmly engaged. Pull on the strap until it lies flat and is close against your child's body. The straps should be correctly adjusted and ensure they are not twisted.

CAUTION

Pull the strap end straight towards you, not upwards or downwards. Please pay attention to the strap end. It should always be attached to the cover while traveling (especially outside the car).

INSTALLATION IN THE VEHICLE

Loosen the shoulder straps by pressing the harness adjusting button and pull the harness shoulder as far forward as possible.

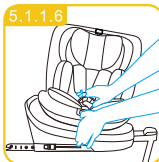

Open the buckle by pressing the red button, then fix the shoulder straps at the sides of the car seat.

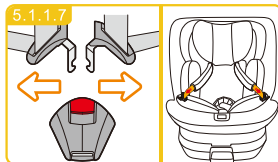

Place child in the car seat.



Please note: A correctly adjusted headrest ensures optimal protection for your child in the child seat; the headrest must be adjusted so that the harness shoulder straps are at the same level as the child's shoulders or slightly above.

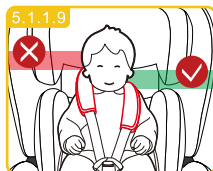

Guide the two buckles together and fasten into the buckle, until you hear an audible "click" sound.

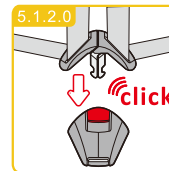

Tighten the harness adjusting strap and make sure the harness is reasonably tight. It should restrain but not make the child uncomfortable.

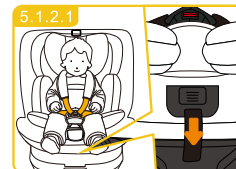

CAUTION

Before every journey, make sure that the rotating part has been fully engaged.
Do not drive unless the seat is in forward or rearward facing position.

CAUTION

The seat can be 360° rotated without limiting (Any angles).

Press the rotating button to adjust the seat direction. Only rearward facing position is available for child 15 months.

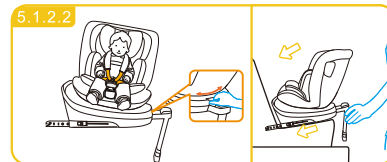

INSTALLATION IN THE VEHICLE

5.2 Installation Instruction for Stature 76-105cm Forward Facing, ISOFIX + Support Leg + Harness

Press the ISOFIX release button to extend the ISOFIX connectors fully.

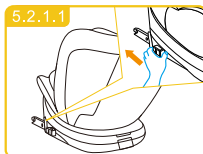

Caution: Only proceed to the next step once the ISOFIX has been fully extended and the red marks are visible.

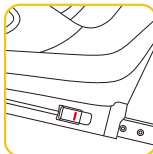

Insert the ISOFIX connectors directly into the anchorages until you hear a distinct "click" sound.



Grasp the main body of the seat to check its stability. Observe the ISOFIX red/green indicator while doing so. If the seat is unstable or the ISOFIX connectors come loose, please repeat the steps and reinstall.

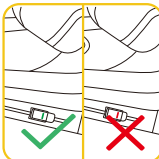

Squeeze the support leg adjusting button, pull out the support leg until it rests firmly on the floor. Observe the ISOFIX red/green indicator to confirm the installation status.

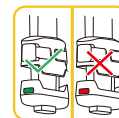
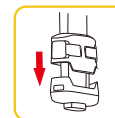

Rotate the seat to the sideward facing position by pressing the rotating button. This will allow easy access for placing the child into the car seat.

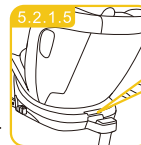

CAUTION

Please ensure that the lap strap is worn low down, so that the pelvis is firmly engaged. Pull on the strap until it lies flat and is close against your child's body. The straps should be correctly adjusted and ensure they are not twisted.

CAUTION

Pull the strap end straight towards you, not upwards or downwards. Please pay attention to the strap end. It should always be attached to the cover while traveling (especially outside the car).

INSTALLATION IN THE VEHICLE

Loosen the shoulder straps by pressing the harness adjusting button and pull the harness shoulder as far forward as possible.

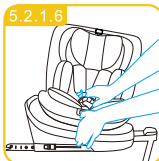

Open the buckle by pressing the red button, then fix the shoulder straps at the sides of the car seat.

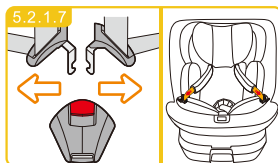

Place child in the car seat.



Please note: A correctly adjusted headrest ensures optimal protection for your child in the child seat; the headrest must be adjusted so that the harness shoulder straps are at the same level as the child's shoulders or slightly above.

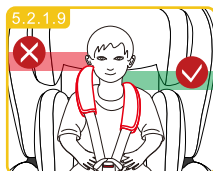

Guide the two buckles together and fasten into the buckle, until you hear an audible "click" sound.

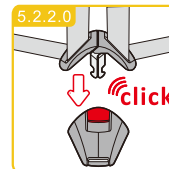

Tighten the harness adjusting strap and make sure the harness is reasonably tight. It should restrain but not make the child uncomfortable.

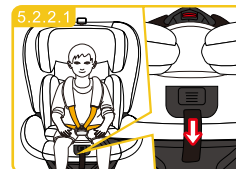

CAUTION

Please ensure that the lap strap is worn low down, so that the pelvis is firmly engaged. Pull on the strap until it lies flat and is close against your child's body. The straps should be correctly adjusted and ensure they are not twisted

CAUTION

Pull the strap end straight towards you, not upwards or downwards. Please pay attention to the strap end. It should always be attached to the cover while traveling (especially outside the car).

Press the rotating button to adjust the seat direction. Both forward and rearward facing position are available for child's stature 76-105cm.

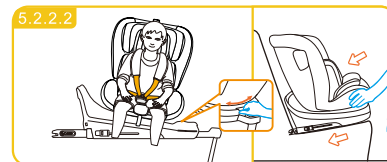

INSTALLATION IN THE VEHICLE

5.3 Installation Instruction for Stature 100-105cm Forward Facing, ISOFIX + 3-Point-Belt

Remove the baby insert, loosen the shoulder straps by pressing the harness adjusting button and pull the harness shoulder strap as far forward as possible.

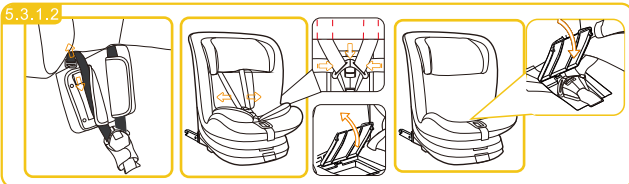
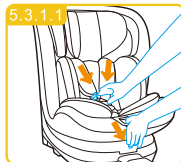

Remove the shoulder belt pads and place the shoulder strap behind the headrest cover, open the cover of buckle storage, then put it in the storage and close finally.

Press the ISOFIX release button to slide the ISOFIX connectors to the end.

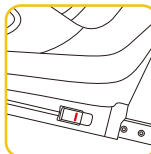

Insert the ISOFIX connectors directly into the anchorage point until you hear an audible "click" sound.



Hold the child seat to ensure it is securely fastened and doesn't shake. At the same time, observe the ISOFIX indicator, which should show green. If the seat is unstable or the ISOFIX connectors come loose, please repeat the installation steps.

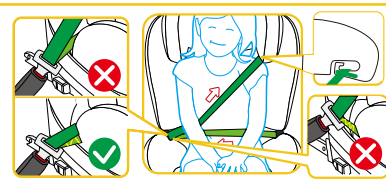
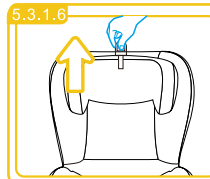
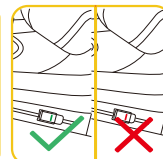

Adjust the height of the headrest to fit your child comfortably. Put the vehicle belt through the belt guide. Place your child into the child seat and let the vehicle belt pass the shoulder and lap belt guide. Fasten the vehicle belt until hear a distinct "click" sound.

CAUTION

Make sure lap strap is worn low down, so that the pelvis is firmly engaged. Pull on the strap until it lies flat and is close against your child's body.

The straps should be correctly adjusted and ensure they are not twisted.

INSTALLATION IN THE VEHICLE

5.4 Installation Instruction for Stature 100-105cm Forward Facing, 3-Point-Belt

Put the safety seat on the car, support leg must be fully storage, refer to 5.0.1.



CAUTION

This unit should be used in a forward upright position only.

CAUTION

The seat can only be rotated when the supporting leg assembly is extended.

CAUTION

Before every journey, make sure that the rotating part has been fully engaged.
Do not drive unless the seat is in forward or rearward facing position.

CAUTION

The seat can be 360° rotated without limiting (Any angles).

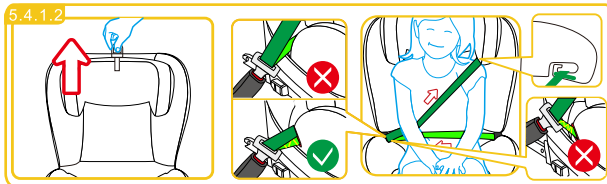

Adjust the height of the headrest to fit your child comfortably. Put the vehicle belt through the belt guide. Place your child into the child seat and let the vehicle belt pass the shoulder and lap belt guide. Fasten the vehicle belt until hear a distinct "click" sound and check that the child and buckle are secure.

CAUTION

Make sure strap lap is worn low down, so that the pelvis is firmly engaged. Pull on the strap until it lies flat and is close against your child's body. The straps should be correctly adjusted and ensure they are not twisted.

CARE INSTRUCTIONS

6.1 Cleaning

Please be sure to use only original seat covers, as the seat cover is important to the proper functioning of the system. Replacement seat covers are available from your retailer and or at branches.

The baby car seat must not be used without the cover.

- The cover can be removed and washed circularly in a washing at 30°C in the neutral detergent. But please read the washing label on the cover carefully before washing. As the color of the cover may fade if washed above 30°C. Wringing or ironing the cover is forbidden (as the fabric may separate from the padding).
- The plastic part of the seat can be cleaned with soapy water. Do not use the strong detergents (such as solvents).
- The harness belt can be cleaned with soapy water.
- Do not remove the socket of the buckle from the strap.

6.2 Security Checking

For security, please read this "security checking" before your traveling. Check if the firmness of the shoulder strap system is suitable for your child, and if the height of the shoulder strap is with the proper height. Regularly check the 5-point harness belt of the seat to ensure no damage. In case of any damage or malfunction, please do not use the baby car seat and contact your supplier (see the address information on the warranty card). If you have any question, please contact the supplier.

6.3 Warranty

We provide a 3-year warranty for this child car seat against manufacturing or material defects. The warranty period begins on the date of purchase. To validate the warranty, please keep the invoice and register your product on jovkids.com.

The Warranty Does Not Cover:

- Natural signs of wear and damage resulting from excessive stress.
- Damage resulting from inappropriate or improper use.
- Color fastness may diminish when exposed to UV radiation. However, all fabrics fade when exposed to UV radiation. This is not a material defect but a normal sign of wear that is not covered by the warranty.
- Buckle malfunction is often due to the accumulation of dirt and dust, which may prevent it from working properly. If this occurs, please check if you can clean it yourself without damaging the buckle. If cleaning does not resolve the issue, please contact after sales service.

For warranty claims, please contact your retailer directly. They will provide the necessary advice and support. When processing claims, product-specific depreciation rates will be applied. Please refer to our General Terms and Conditions, which are available from your retailer.