

ECOVACS

**Deebot N10
Robot Vacuum**



ECOVACS Deebot N10 Robot Vacuum Instruction Manual

[Home](#) » [ECOVACS](#) » ECOVACS Deebot N10 Robot Vacuum Instruction Manual 

Contents

- 1 [ECOVACS Deebot N10 Robot Vacuum](#)
- 2 [Important Safety Instructions](#)
- 3 [Package Contents](#)
- 4 [Maintenance](#)
- 5 [Troubleshooting](#)
- 6 [Technical Specifications](#)
- 7 [Documents / Resources](#)
 - 7.1 [References](#)



ECOVACS Deebot N10 Robot Vacuum



Live Smart. Enjoy Life.

Should you encounter situations that have not been properly addressed in this Instruction Manual, please contact our Customer Service Center where a technician will be able to help you with your specific problem or question. For more information, please visit the ECOVACS ROBOTICS official website: www.ecovacs.com The company reserves the right to make technological and/or design changes to this product for continuous improvement. Thank you for choosing DEEBOT!

Important Safety Instructions







When using an electrical Appliance, basic precautions should always be followed, including the following:

READ ALL INSTRUCTIONS BEFORE USING THIS APPLIANCE SAVE THESE INSTRUCTIONS

1. This Appliance is not intended for use by persons (including children) with reduced physical, sensory, or mental capabilities, or lack of experience and knowledge unless they have been given supervision or instruction concerning the use of the Appliance by a person responsible for their safety.
2. Children should be supervised to ensure that they do not play with the Appliance.
3. Clear the area to be cleaned. Remove power cords and small objects from the floor that could entangle the Appliance. Tuck rug fringe under the rug base, and lift items such as curtains and tablecloths off the floor.
4. If there is a drop-off in the cleaning area due to a step or stairs, you should operate the Appliance to ensure that it can detect the set p without falling over the edge.
5. It may become necessary to place a physical barrier at the edge to keep the unit from falling. Make sure the physical barrier is not a trip hazard.
6. Only use as described in this manual. Only use attachments recommended or sold by the manufacturer.
7. Please make sure your power supply source voltage matches the power voltage marked on the Docking Station.
8. For INDOOR household use ONLY. Do not use the Appliance in outdoor, commercial, or industrial environments.

9. Use only the original rechargeable battery and A docking Station is provided with the Appliance from the manufacturer.
10. Non-rechargeable batteries are prohibited. For battery information, please refer to the Specifications section.
11. Do not use without a dust bin and/or filters in place.
12. Do not operate the Appliance in an area where there are lit candles or fragile objects.
13. Do not use in extremely hot or cold environments (below -5°C/23°F or above 40°C/104°F).
14. Keep hair, loose clothing, fingers, and all parts of the body away from any openings and moving parts.
15. Do not operate the Appliance in a room where an infant or child is sleeping.
16. Do not use the Appliance on wet surfaces or surfaces with standing water.
17. Do not allow the Appliance to pick up large objects like stones, large pieces of paper, or any item that may clog the Appliance.
18. Do not use Appliances to pick up flammable or combustible materials such as gasoline, printer o, or copier toner, or use in areas where they may be present.
19. Do not use the Appliance to pick up anything that is burning or smoking, such as cigarettes, matches, hot ashes, or anything that could cause a fire.
20. Do not put objects into the suction intake. Do not use it if the suction intake is blocked. Keep the intake clear of dust, lint, hair, or anything that may reduce airflow.
21. Take care not to damage the power cord. Do not pull on or carry the Appliance or Docking Station by the power cord, use the power cord as a handle, close a door on the power cord, or pull the power cord around sharp edges or corners. Do not run the Appliance over the power cord. Keep the power cord away from hot surfaces.
22. If the power cord is damaged, it must be replaced by the manufacturer or its service agent to avoid a hazard.
23. Do not use the Docking Station if it is damaged. The power supply is not to be repaired and not to be used any longer if it is damaged or defective.
24. Do not use a damaged power cord or receptacle. Do not use the Appliance or Docking Station if it is not working properly, has been dropped, damaged, left outdoors, or comes in contact with water. It must be repaired by the manufacturer or its service agent to avoid a hazard.
25. Turn OFF the power switch before cleaning or maintaining the Appliance.
26. The plug must be removed from the receptacle before cleaning or maintaining the Docking Station.
27. Remove the Appliance from the Docking Station, and turn OFF the power switch to the Appliance before removing the battery for disposal of the Appliance.
28. The battery must be removed and discarded according to local laws and regulations before disposal of the Appliance.
29. Please dispose of used batteries according to local laws and regulations.
30. Do not incinerate the Appliance even if it is severely damaged. The batteries can explode in a fire.
31. When not using the Docking Station for a long period, please unplug it.
32. The Appliance must be used according to the directions in this Instruction Manual. ECOVACS ROBOTICS cannot be held liable or responsible for any damages or injuries caused by improper use.
33. The robot contains batteries that are only replaceable by skilled persons. To replace the robot's battery, please contact Customer Service.
34. If the robot will not be used for a long time, Power off the robot for storage and unplug the Docking Station.
35. **WARNING:** For recharging the battery, only use the detachable supply unit CH1822 provided with the Appliance, or CH1918 is sold separately as an accessory.
36. This Appliance can be used by children aged 8 years and above and persons with reduced physical, sensory, or mental capabilities or lack of experience and knowledge if they have been given supervision or instruction

concerning the use of the Appliance in a safe way and understand the hazards involved. Children shall not play with the Appliance. Cleaning and user maintenance shall not be done by children without supervision. (For Europe) To satisfy RF exposure requirements, a separation distance of 20 cm or more should be maintained between this device and the persons during device operation.

	Class II
	Short-circuit-proof safety isolating transformer
	Switch mode power supply
	For indoor use only
	Direct current
	Alternating current

37. To ensure compliance, operations at closer than this distance are not recommended. The antenna used for this transmitter must not be co-located in conjunction with any other antenna or transmitter.

EU Countries

For EU Declaration of Conformity information, visit <https://www.ecovacs.com/global/compliance>

Correct Disposal of this Product

This marking indicates that this product should not be disposed of with other household waste throughout the EU. To prevent possible harm to the environment or human health from uncontrolled waste disposal, recycle it responsibly to promote the sustainable reuse of material resources. To recycle your used device, please use the return and collection systems or contact the retailer where the product was purchased. They can safely recycle this product.

Package Contents

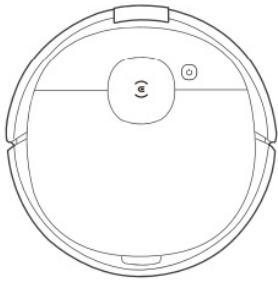

Robot

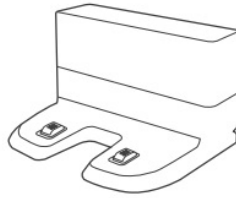

Docking Station



Instruction Manual

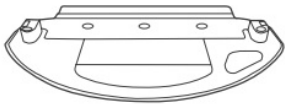

Mopping Pad Plate

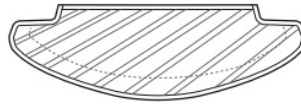

Washable Mopping Pad

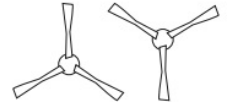

Side Brushes

Note: Figures and illustrations are for reference only and may differ from actual product appearance. Product design and specifications are subject to changes without notice.

Product Diagram

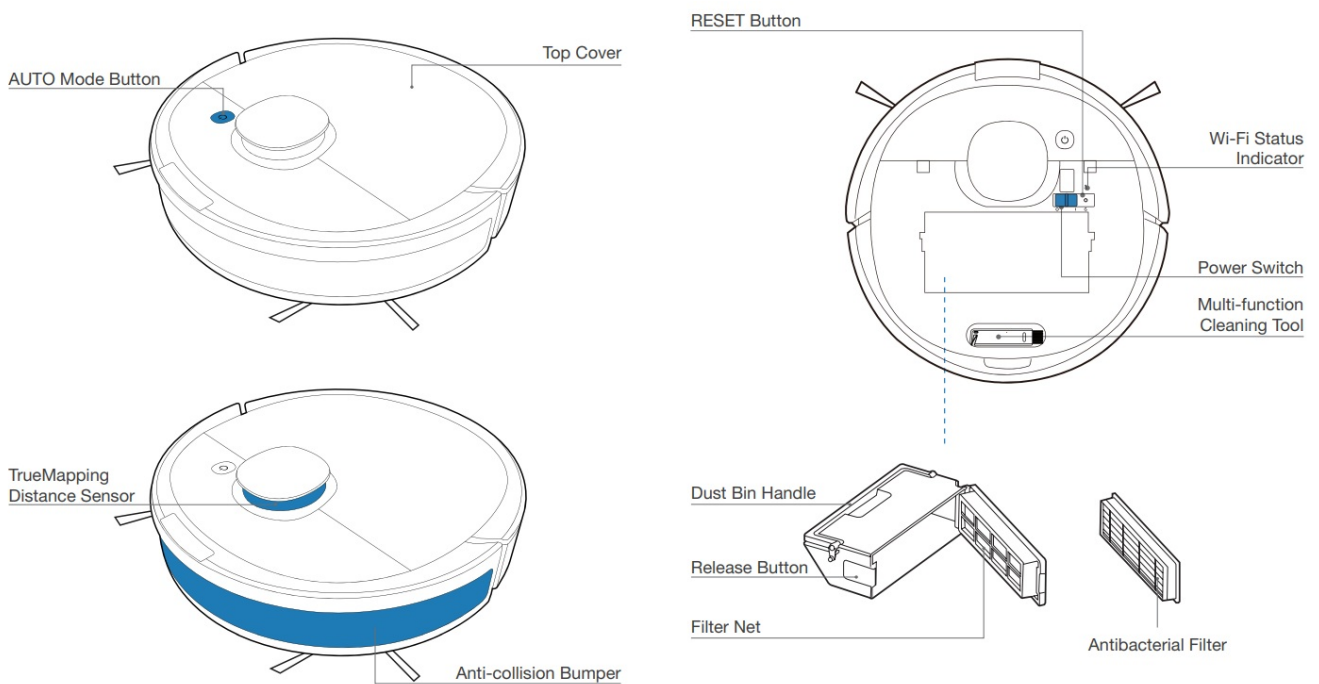

Bottom View

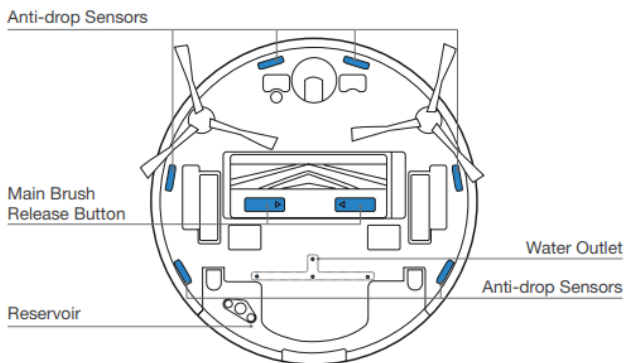
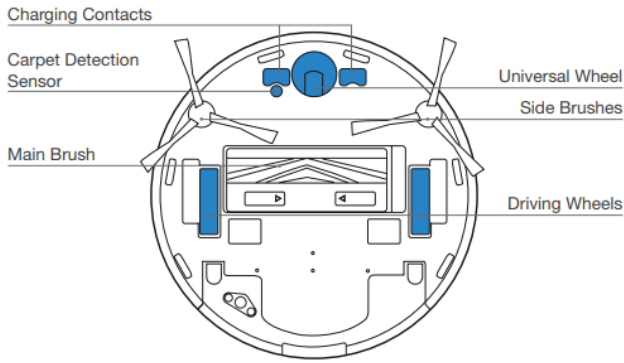

Docking Station

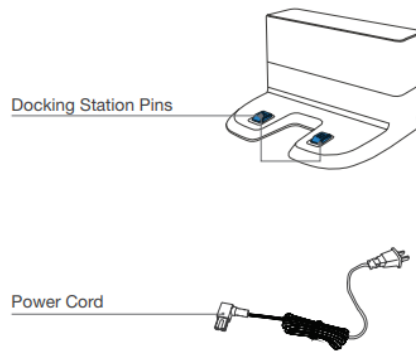

Reservoir

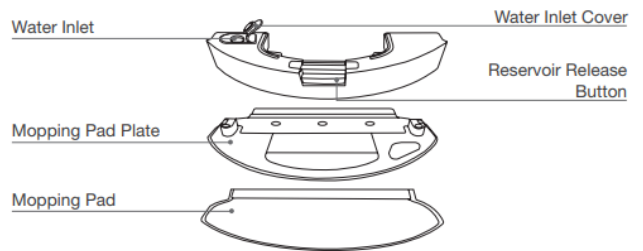

Notes Before Cleaning

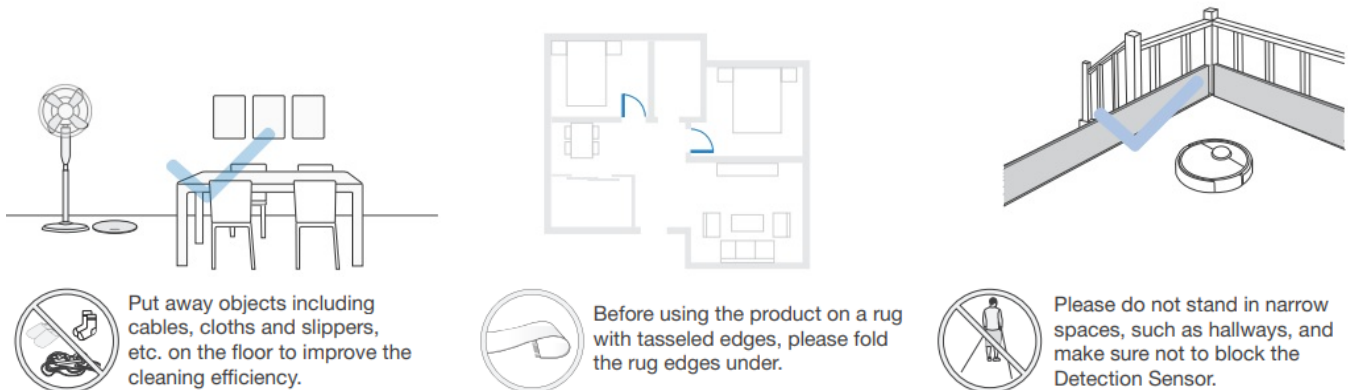

- Tidy up the area to be cleaned by putting furniture, such as chairs, in their proper place.
- During the first use, make sure each room door is open to help DEEBOT fully explore your house.
- It may be necessary to place a physical barrier at the edge of a drop to stop the unit from falling over the edge.
- Put away objects including cables, clothes, slippers, etc. on the floor to improve the cleaning efficiency.
- Before using the product on a rug with tasseled edges, please fold the rug edges under.
- Please do not stand in narrow spaces, such as hallways, and make sure not to block the Detection Sensor.

Quick Start

1. remove Protective Strips and Films

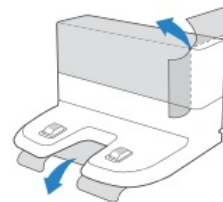
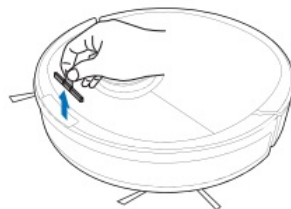
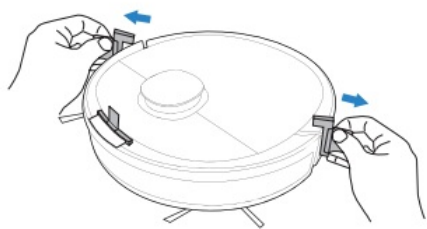

2. Assemble the Docking Station

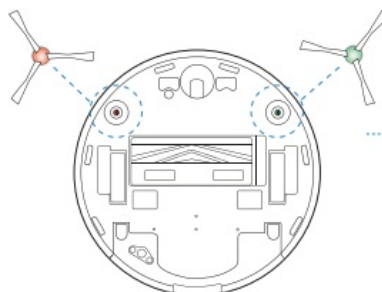
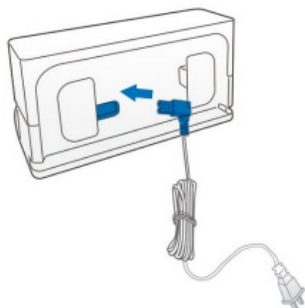

3. and install Side Brushes

Charging DEEBOT

1. Docking Station Placement

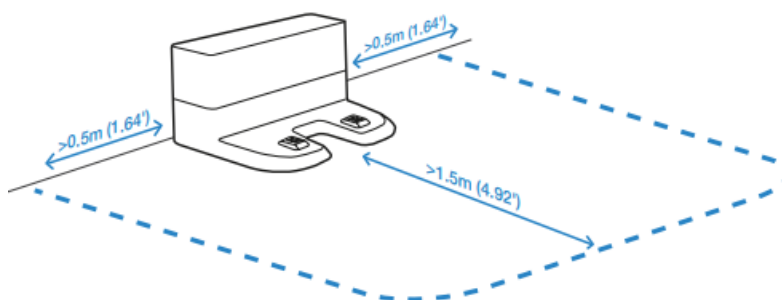

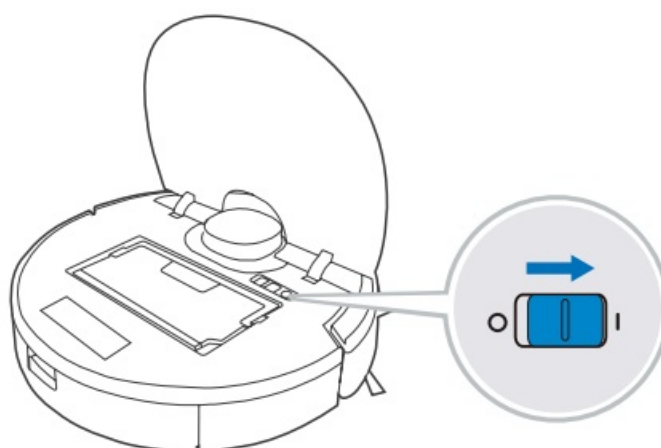

2. Power ON

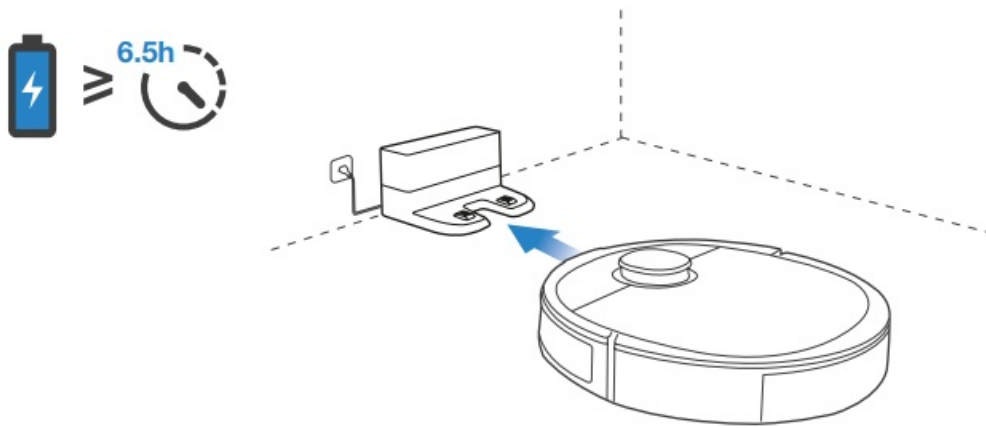

3. Charge DEEBOT

Note: I = ON, O = OFF.



- DEEBOT cannot be charged when being powered OFF.
- Empty the remaining water from the Reservoir and remove the Reservoir and the mopping pad plate before charging DEEBOT.  flashes when DEEBOT is charging. goes out  when DEEBOT is fully charged.
- You can also purchase an Auto-Empty Station that automatically empties your DEEBOT's dustbin. Explore more accessories at www.ecovacs.com/global.

Operating and Programming/3.4 ECOVACS HOME App

To enjoy all available features, it is recommended to control your DEEBOT via the ECOVACS HOME app

Before you start, make sure that

- Your mobile phone is connected to a Wi-Fi network.
- The 2.4GHz band wireless signal is enabled on your router.
- The Wi-Fi indicator light on DEEBOT is slowly flashing.

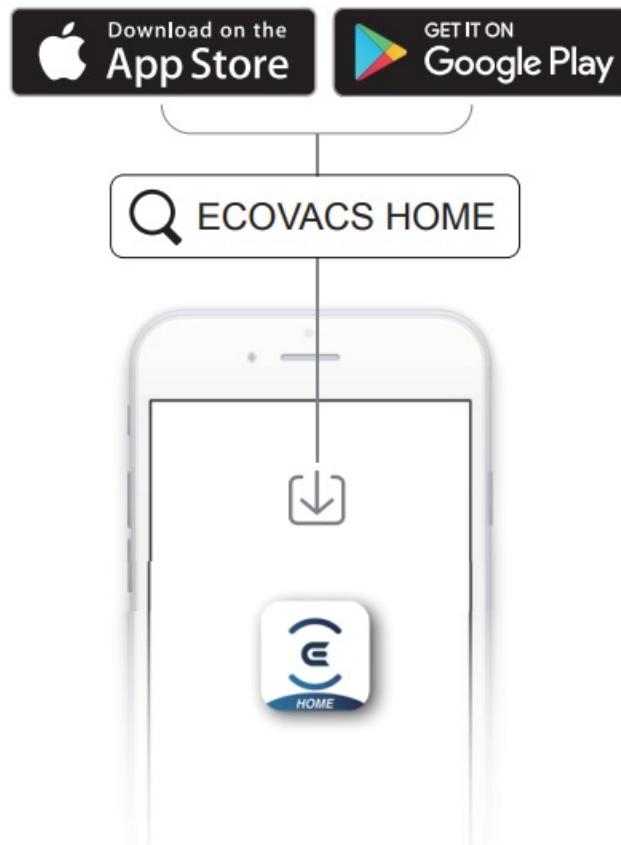

Wi-Fi Indicator Light

	Slowly flashing	Disconnected to Wi-Fi or waiting for Wi-Fi connection
	Rapidly flashing	Connecting to Wi-Fi
	Solid	Connected to Wi-Fi

Tips

If you have any problems during the Wi-Fi setup process, refer to the Troubleshooting > Wi-Fi Connection section in this manual.

Operating and Programming/3.5 Operating DEEBOT

During the first cleaning, please supervise DEEBOT and assist it should there be a problem.

1. Start

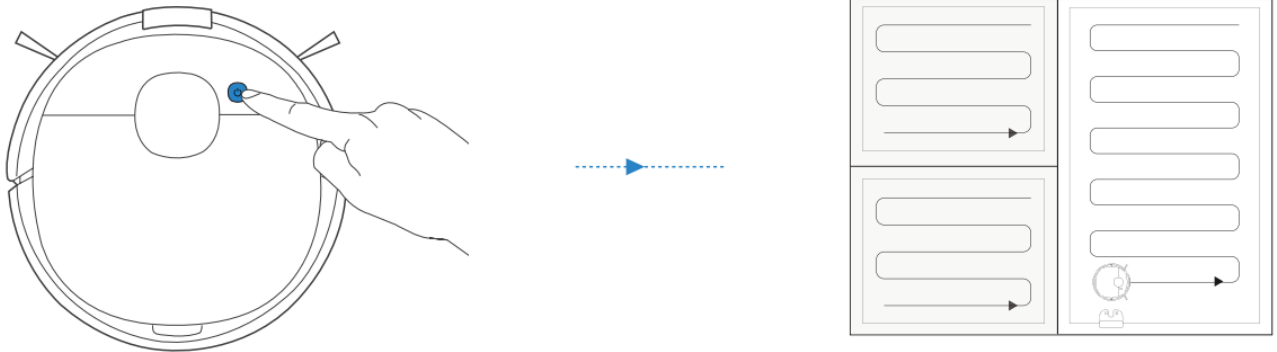

2. Pause

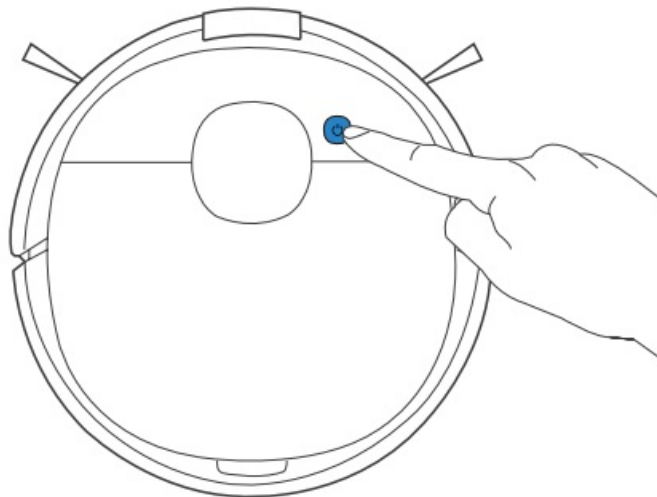

3. Return to Charge Pressing for 3 seconds to send DEEBOT back to the Docking Station.

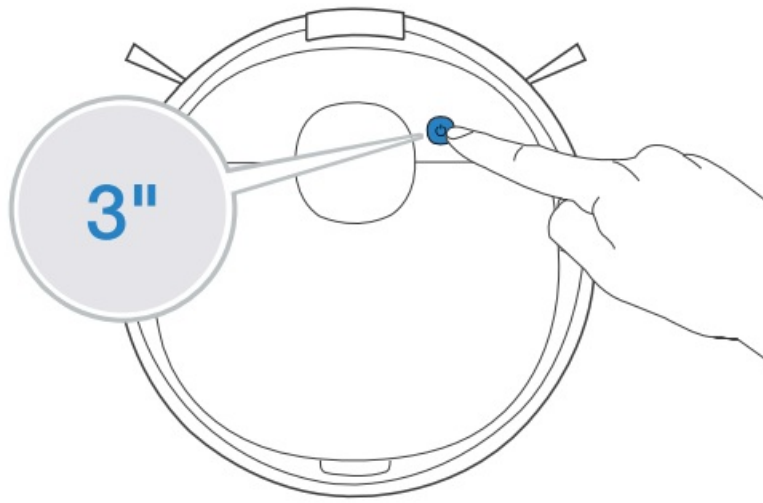

Note: The robot's Control Panel stops glowing after the robot is paused for a few minutes. Press the AUTO Mode Button on DEEBOT to wake up the robot.

OZMO Mopping System

- Note:** To prolong the service life of the reservoir, it is recommended to use purified water or softened water for the OZMO mopping system.

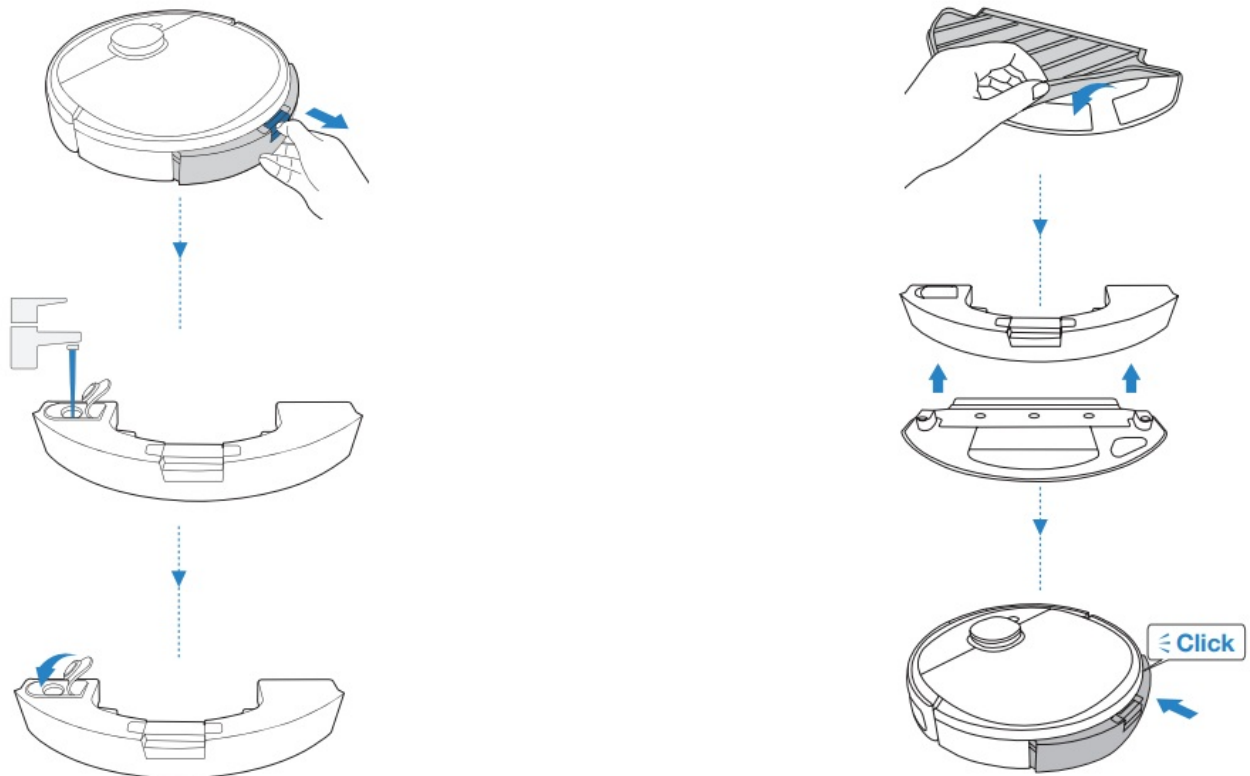

- Note:** When DEEBOT is mopping, DEEBOT automatically detects the carpet and keeps away from it. If you need to clean the carpet, please uninstall the mopping pad plate first.

Maintenance

Robot Part	Maintenance Frequency	Replacement Frequency
Washable Mopping Pad	After each use	Every 50 washes
Reservoir/Mopping Pad Plate	After each use	/
Side Brush	Once every 2 weeks	Every 3-6 months
Main Brush	Once per week	Every 6-12 months
Antibacterial Filter	Once per week	Every 3-6 months
Universal Wheel Anti-Drop Sensors Bumper Charging Contacts Docking Station Pins	Once per week	/

To keep DEEBOT running at peak performance, perform maintenance tasks and replace parts with the following frequencies: A multi-function Cleaning Tool is provided for easy maintenance. Handle with care, this cleaning tool has sharp edges.

Note: ECOVACS manufactures various replacement parts and fittings. Please contact Customer Service for more information on replacement parts.

Mopping System

Before performing cleaning and maintenance tasks on DEEBOT, turn the robot OFF and unplug the Docking Station. Washable Mopping Pad Clean the water inlet filter on the bottom of the Reservoir if it is clogged.

1

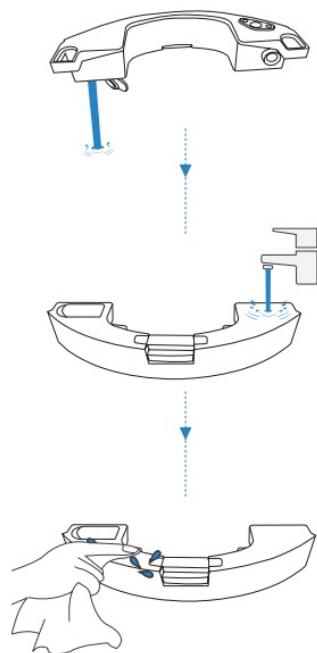

2 Washable Mopping Pad

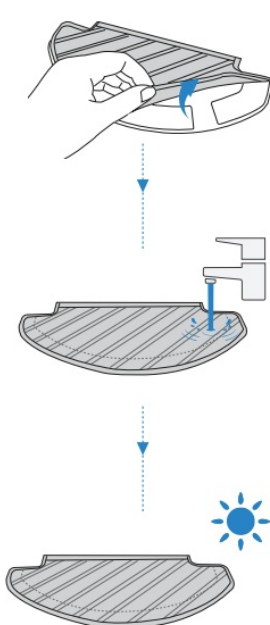

! Clean the water inlet filter on the bottom of the Reservoir if it is clogged.

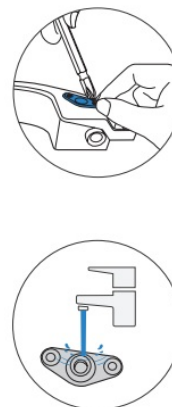

Dust Bin and Filters

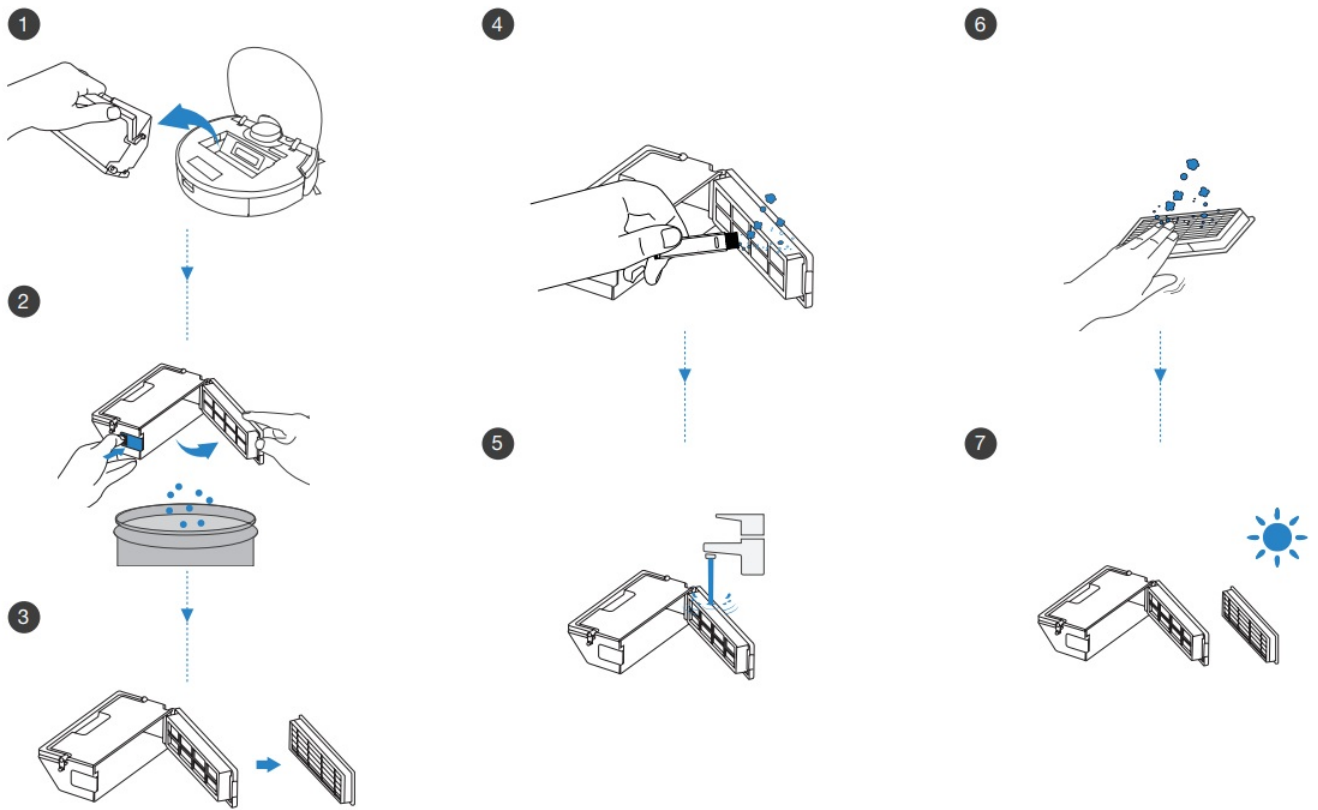

Main Brush and Side Brushes

Main Brush

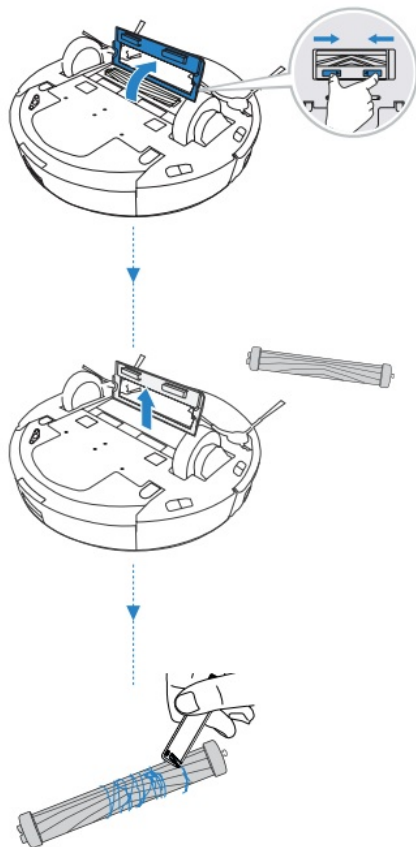

Side Brushes

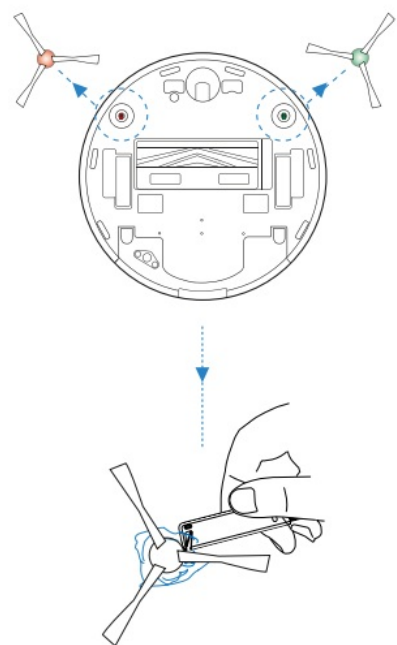

Other Components

Note: Before cleaning the robot's Charging Contacts and Docking Station Pins, turn the robot OFF and unplug the Docking Station.

1

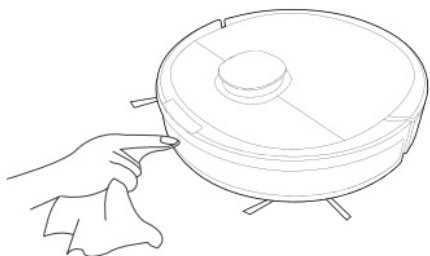

2

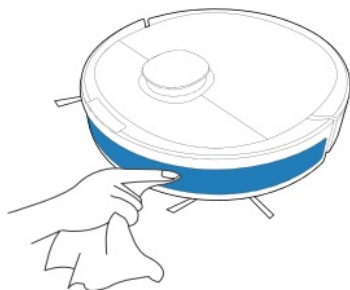

3

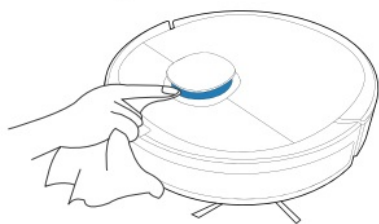

6

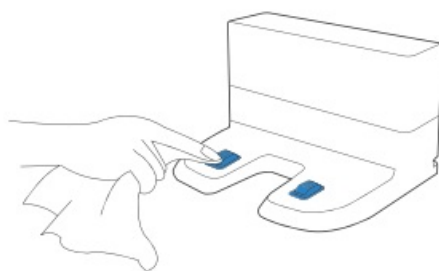

4

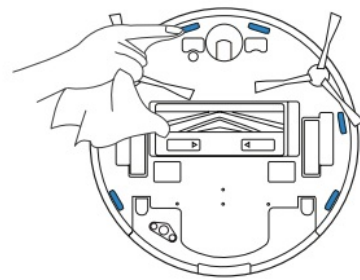

5

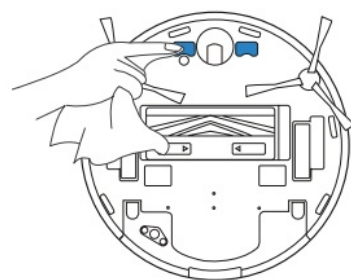

7

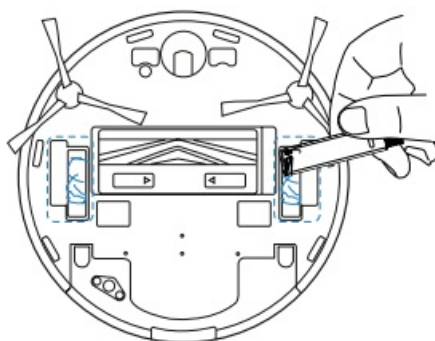

8

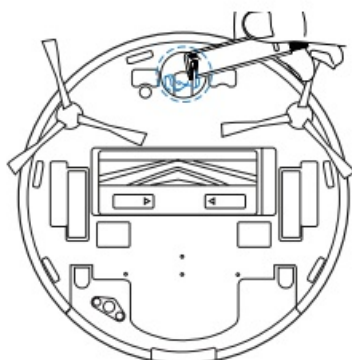

Storage

If DEEBOT will not be used for a while, fully charge DEEBOT and power OFF before storage. Charge DEEBOT every 1.5 months to prevent battery drain.

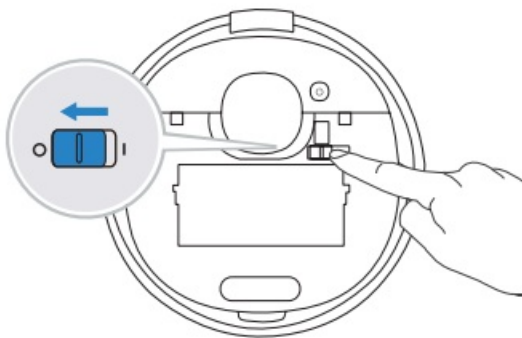

Note: When DEEBOT is not cleaning, it is recommended to keep DEEBOT powered ON and charging.

Indicator Light

DEEBOT will tell you something is wrong with an indicator light and voice report. More detailed support is available through the ECOVACS HOME and online website.

Indicator Light	Scenario
AUTO Mode Button glows a solid WHITE.	The robot is cleaning.
	The robot pauses while cleaning.
AUTO Mode Button flashes WHITE.	The robot is charging.
	The robot is starting.
	The robot is relocating.
AUTO Mode Button glows a solid RED.	The robot has a low battery.
AUTO Mode Button flashes RED.	The robot has a problem.

Troubleshooting

N o.	Malfunction	Possible Causes	Solutions
1	DEEBOT is not charging.	DEEBOT is not switched ON.	Switch ON DEEBOT.
		DEEBOT has not connected to the Docking Station.	Be sure that the robot's Charging Contacts are connected to the Docking Station Pins.
		The Power Cord is not connected to the Docking Station.	Make sure the Power Cord is firmly connected to the Docking Station.
		The Docking Station is not connected to the power supply.	Make sure the Docking Station is connected to the power supply.
		The battery is completely discharged.	Please contact Customer Care for help.
2	DEEBOT cannot return to the Docking Station.	The Docking Station is not correctly placed.	Refer to section 3.3 to correctly place the Docking Station.
		The Docking Station is not correctly connected.	Make sure the Docking Station is correctly connected.
		The Docking Station is manually moved during the cleaning.	It is suggested not to move the Docking Station during the cleaning.
		DEEBOT is paused for more than 90 minutes.	It is suggested not to pause DEEBOT for more than 90 minutes.
		DEEBOT did not start cleaning from the Docking Station.	Make sure DEEBOT starts cleaning from the Docking Station.
3	DEEBOT gets stuck while working and stops.	DEEBOT is tangled with something on the floor (electrical wires, curtains, carpet fringing, etc.).	DEEBOT will try various ways to free itself. If it is unsuccessful, manually remove the obstacles and restart.
		DEEBOT might be stuck under furniture with an entrance of similar height.	Please set a physical barrier, or set a Virtual Boundary in the ECOVACS HOME App.

N o.	Malfunction	Possible Causes	Solutions
4	DEEBOT returns to the Docking Station before it has finished cleaning.	Working time varies according to floor surface, room complexity, and the Cleaning Mode selected. When the battery gets low, DEEBOT automatically switches to Recharge Mode and returns to the Docking Station to recharge itself.	Turn on the Continuous Cleaning function in the ECOVACS HOME App. DEEBOT will automatically resume the uncompleted cleaning cycle when Continuous Cleaning is enabled.
		DEEBOT is unable to reach certain areas blocked by furniture or barriers.	Tidy up the area to be cleaned by putting furniture and small objects in their proper place.
		The Docking Station is too distant from the center of the house.	Please place the Docking Station against the wall of a central room of the house.
5	DEEBOT does not clean automatically at the scheduled time.	The time Scheduling function is canceled.	Program DEEBOT to clean at specific times using the ECOVACS HOME App.
		DEEBOT is switched OFF.	Switch ON DEEBOT.
		The robot's battery is low.	Keep DEEBOT switched ON and connected to the Docking Station to make sure it has a full battery to work at any time.
6	The water is not coming out of the Reservoir when DEEBOT is mopping.	The water inlet filter on the bottom of the Reservoir is clogged.	Unscrew the water inlet on the bottom of the Reservoir and clean the filter as described in Section 4.2.
		The Reservoir runs out of water.	Add water into the Reservoir.
		The water outlets on the bottom of DEEBOT are clogged.	Check the water outlets on the bottom and clean them.

N o.	Malfunction	Possible Causes	Solutions
7	DEEBOT misses cleaning spots to be cleaned or repeats cleaning the area cleaned.	The cleaning cycle is interfered with by small objects or barriers on the floor.	Remove power cords and small objects from the floor to ensure cleaning efficiency. DEEBOT will automatically clean the area missed, please avoid moving DEEBOT manually or block the path during the cleaning cycle.
		DEEBOT is working on slippery polished floors.	Make sure the floor wax is dried before DEEBOT starts cleaning.
		DEEBOT is unable to reach certain areas blocked by furniture or barriers.	Tidy up the area to be cleaned by putting furniture and small objects in their proper place.
		The TrueMapping Distance Sensor is blocked.	Remove the objects that are blocking the TrueMapping Distance Sensor.

8	DEEBOT is making too much noise when cleaning.	DEEBOT is tangled or blocked with debris.	Clean DEEBOT as described in section 4 Maintenance and restart. If the trouble persists, please contact Customer Care.
9	DEEBOT is not able to connect to the home Wi-Fi network.	Incorrect home Wi-Fi username or password entered.	Enter the correct home Wi-Fi username and password.
		Incorrect App installed.	Please download and install the ECOVACS HOME App.
		DEEBOT is not within range of your home Wi-Fi signal.	Make sure DEEBOT is within range of your home Wi-Fi signal.
		The network setup started before DEEBOT was ready.	Turn ON the Power Switch. Press the RESET Button. DEEBOT is ready for network setup when its Wi-Fi Indicator light flashes slowly.
		DEEBOT does not support 5 GHz Wi-Fi.	Make sure the robot has been connected to a 2.4 GHz Wi-Fi network.
10	DEEBOT does not clean the whole area.	The cleaning area is not tidy.	Remove small objects from the floor and tidy up the cleaning area before DEEBOT starts cleaning.
11	DEEBOT reservoir drops out of place during use.	The reservoir is not correctly installed.	Make sure the DEEBOT reservoir clicks into place when installing.
12	DEEBOT Side Brushes drop out of place during use.	The Side Brushes are not correctly installed.	Make sure the Side Brushes click into place when installing.

Wi-Fi Connection

Before Wi-Fi setup, make sure DEEBOT, mobile phone, and Wi-Fi network meet the following requirements.

DEEBOT and Mobile Phone Requirements

- DEEBOT is fully charged and the power switch of DEEBOT is turned on.
- The Wi-Fi status light slowly flashes.
- Turn off the mobile phone's cellular data (you can turn it back on after setup).

Wi-Fi Network Requirements

- You are using a 2.4GHz or 2.4/5 GHz mixed network.
- Your router supports 802.11b/g/n and IPv4 protocol.

- Do not use a VPN (Virtual Private Network) or Proxy Server.
- Do not use a hidden network.
- WPA and WPA2 using TKIP, PSK, AES/CCMP encryption.
- WEP EAP (Enterprise Authentication Protocol) is not supported.
- Use Wi-Fi channels 1-11 in North America and channels 1-13 outside North America (refer to local regulatory agency).
- If you are using a network extender/repeater, the network name (SSID) and password are the same as your primary network.

Technical Specifications

Model	DBX41					
Rated Input			20V		1A	
Docking Station Model	CH1822			CH1918 (Sold Separately)		
	Input	100-240V	50-60Hz 0.5A	Rated Input (Charging)		220-240V 50-60Hz 0.3A
	Output	20V	1A	Rated Output		20V 1A
	/			Power (Auto-Emptying)		1000W
Frequency bands	2400-2483.5MHz					
Off Mode Power	Less than 0.50W					
Networked Standby Power	Less than 2.00W					

The output power of the Wi-Fi module is less than 100mW.

Note: Technical and design specifications may be changed for continuous product improvement.

Ecovacs Robotics Co., Ltd
No.518 Songwei Road, Wusongjiang Industry Park, Guoxiang Street,
Wuzhong District, Suzhou, Jiangsu, China.

Documents / Resources

	ECOVACS Deebot N10 Robot Vacuum [pdf] Instruction Manual 104047, 7854-N10-AU, Deebot N10 Robot Vacuum, Deebot N10, Deebot N10 Vacuum, Robot Vacuum, Deebot Vacuum, N10 Vacuum, Vacuum, N10
---	---

References

- [ECOVACS Official Website - ECOVACS US](#)
- [Robot Vacuum Cleaners | Auto Cleaning Robots - ECOVACS Website - ECOVACS](#)
- [User Manual](#)

Manuals+. Privacy Policy

This website is an independent publication and is neither affiliated with nor endorsed by any of the trademark owners. The "Bluetooth®" word mark and logos are registered trademarks owned by Bluetooth SIG, Inc. The "Wi-Fi®" word mark and logos are registered trademarks owned by the Wi-Fi Alliance. Any use of these marks on this website does not imply any affiliation with or endorsement.