

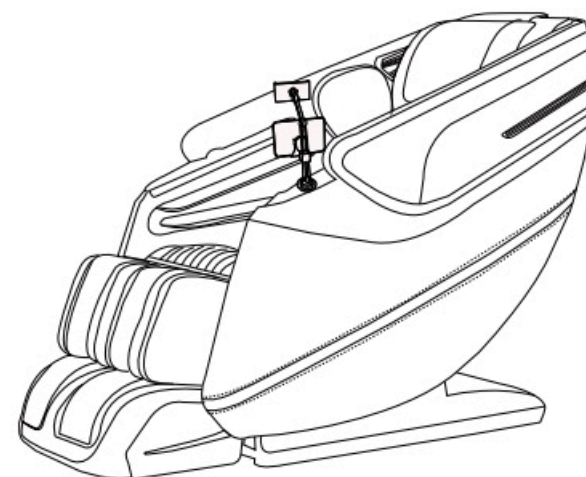

**MASSAGE CHAIR**

**MODEL:Aquasonic S33**



**User manual**

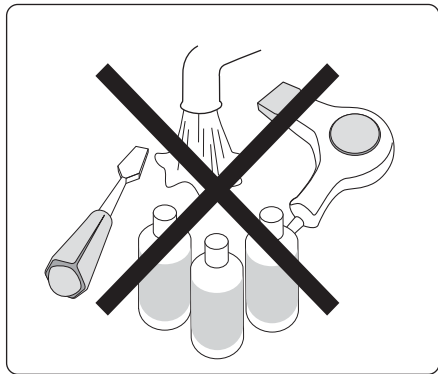

- Turn OFF and pull out the power plug before clean the massage chair, do not touch the power plug with wet hands.

- Use dry cloth to wipe and sweat and other besmirch.

- Please use neutral wash to wipe and lightly brush the chair.

- Please airing.

- Do not use water to clean the chair.

- Do not use alcohol, benzene wash and etc.

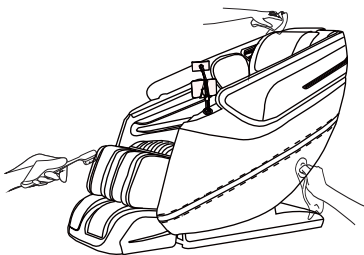

Please read and follow all safety and operating instructions listed in this user manual prior to use. Basic precautions should always be used when operating.

Safety Instructions	-----2-3
Product Specifications	-----4
Product Components	-----5-6
Chair Installation	-----7-8
Before Use	-----9
Remote Controller	-----10-11
Operation Guide	-----12-22
Trouble Shooting	-----23
Maintenance	-----24

Note: Our company reserves the right to revise the design and description of this product without any further notice.

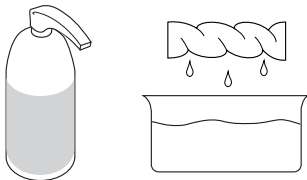

# SAFETY INSTRUCTIONS

### Warning

The power plug must insert properly to the power outlet. If the connection of power plug is not connected properly it can result the risk of electric shock.  
Do not modify the power plug provided with the product. If the outlet is not suitable. Please make sure that the power outlet is properly installed by a qualified electrician. When using the massage chair, basis precautions should always be followed to reduce the risk of electric shock.

1. Please ensure that you plug the massage chair into a proper electrical outlet.
2. Make sure the power plug is securely inserted into the proper electrical outlet to reduce the risk of short-circuit and fire.
3. Always unplug the massage chair from the electrical outlet immediately after use and before cleaning.
4. Do not use the massage chair in places where the humidity is high.
5. Do not use the massage chair outdoors and avoid place with direct sunlight.
6. If the power goes off during use, be sure to turn the power switch to the off position and pull the power plug out from the socket to prevent damage from occurring when the power is restored.
7. Never operate the massage chair if the power cord is wet or damaged.
8. Never plug/unplug the power cord from the socket with wet hands.
9. Close and continuous supervision is necessary when this appliance is being used by on or near children, invalid or disabled person.
10. Use this appliance only for its intended use as described in this use manual.
11. Do not use any parts not from factory.
12. Do not stand, sit or jump in the calves rest when masage chair is in use to prevent any injury to person.
13. Do not attempt to stand on the backrest and armrest to prevent any injury to person.
14. Be careful not to fall asleep during the massage session.
15. Always keep the massage chair clean and never insert any object into the gaps on and around the massage chair.
16. Do not move the massage chair by pulling the power supply cord.
17. Always check whether the surface of the massage chair is torn or ripped before usage, if you found any unfamiliar rips in any area of the cloth in the backrest, do not use the massage chair, kindly contact the service centre immediately for repair.
18. This appliance is designed for household use only.
19. For those suffering from illnesses, please consult your doctor for advice prior to use.

# TROUBLE SHOOTING

If the sounds or movements are not normal, please turn off the massage chair and remove the plug from the electric outlet. Please contact the customer service department for further assistance.

Problem	Solution
The massage chair is connected to power but is not functioning.	1. Check to see if the power plug is inserted properly or if the power outlet is functioning properly. 2. Check to see if the main power switch is in the "I" position.
The remote controller is responding, but the massage chair is not functioning.	The massage chair may have automatically shut down due to overheating protection devices. Please turn off the power and allow the chair to cool off for 30-50 minutes.
Both the remote controller and massage chair are not responding.	The massage chair automatically turns into "full stop" or into "idle" mode when a massage program is completed. Please press the power button again to turn on the chair.

## OPERATION GUIDE

### 11.The method of playing the bluetooth music in massage chair:

A: Match: Open the bluetooth function in mobile phone or Ipad, and search nearby. choose the massage chair bluetooth function music equipment and match with it.

B: Play music: After matching with it, you can display the music by mobile or APP music display software.

#### Attention:

Please off the bluetooth connection when not in use so as for other devices to connect smoothly.

### 12.After use

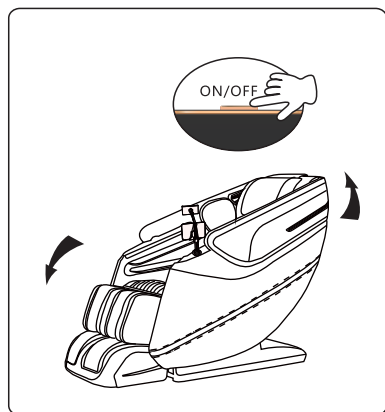

1) Press the power button to power off the massage chair.

\*Make sure whether there are no barriers around the massage chair.

2) Get up when massage chair rest to initial state

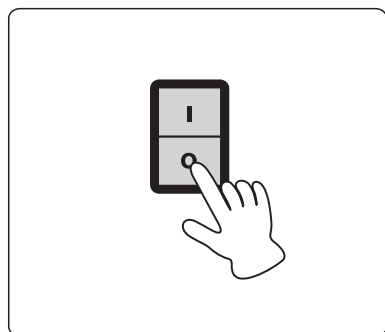

3) Turn off the main power switch.

4) Remove plug from power outlet.

\* Please do not pull on the power cord to remove the plug.

\* Please do not unplug with wet hands.

## SAFETY INSTRUCTIONS

20. The following persons are requested to consult a doctor prior to use in order to reduce the risk of user feeling sick or suffering from injury

- Those who have malignant tumor
- Those who suffer from heart disease
- Those who are experiencing pregnancy, menstruation and puerperal fever
- Those who require complete rest
- Those who are under medical treatment
- Those who suffer from back problem or whose backbone is abnormal or bent
- Those who have osteoporosis

21. If you experience pain during usage, stop using the massage chair immediately, if any injuries occur, seek medical treatment immediately.

22. Never massage the swollen or inflamed parts of the body.

23. This product is non-professional appliance designed to provide a comfortable massage. do not use this product as substitute for medical treatment.

24. Each massage session should not exceed 30 minutes. massage the targeted area only for 15mins, over-massaging can lead to overheating , thus giving the appliance a shorter lifespan.

25. Do not operate where aerosol(spray) product are used or where oxygen is being administered.

26. The massage chair is not suitable for children aged 14 and below.

#### NOTE:

- This appliance is not intended for use by persons(including children) with reduced physical sensory or mental capabilities, or lack of experience and knowledge, unless they have been given supervision or instruction concerning use of the appliance by a person responsible for their safety.
- If the supply cord is damaged,it must be replaced by manufacturer,its service agent or similarly qualified persons in order to avoid a hazard.
- The appliance heats up during operation. persons sensitive to heat must take extra caution when using the appliance.

PRODUCT SPECIFICATIONS

Description	Specifications
Product Name	Massage chair
Model No.	Model: Aquasonic S33
Rated Voltage	110-220V~
Rated Frequency	50Hz
Rated Power Consumption	120W
Carton Dimension	1450MM(L)*760MM(W)*870MM(H)
Weight	N.W: 68KGS G.W:79KGS

OPERATION GUIDE

9. Mainpage

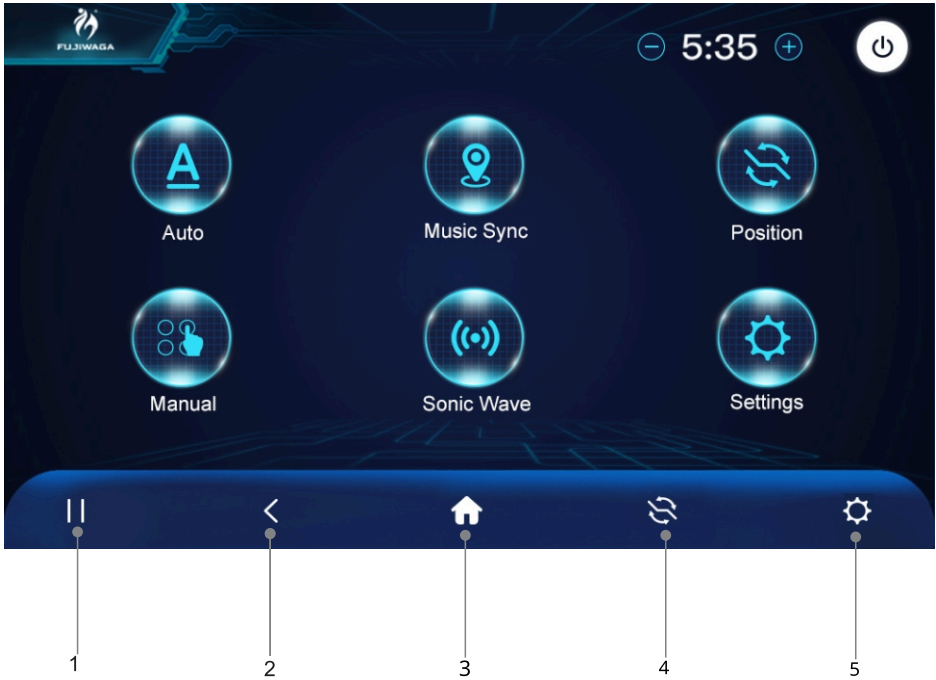

- 1 Pause
- 2 Back
- 3 Home
- 4 Zero gravity
- 5 Settings

There are in total 24 auto programs:  
8 auto+8 Music Sync+8 Sonic wave

# OPERATION GUIDE

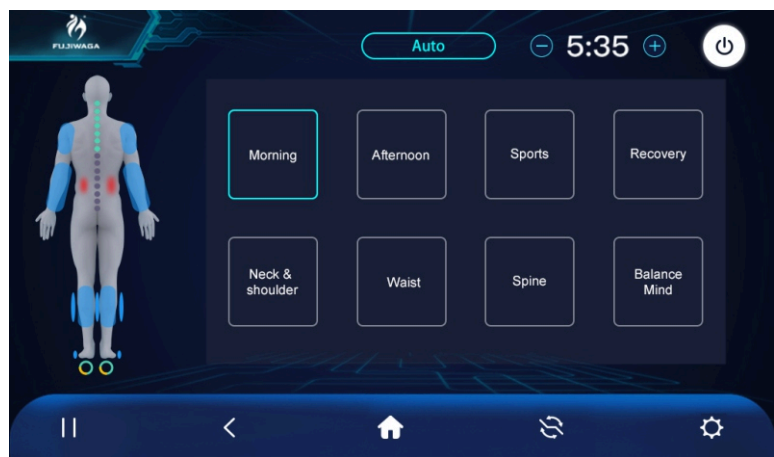

8 auto programs: Morning, Afternoon, Sports, Recovery, Neck & shoulder, Waist, Spine, Balance Mind

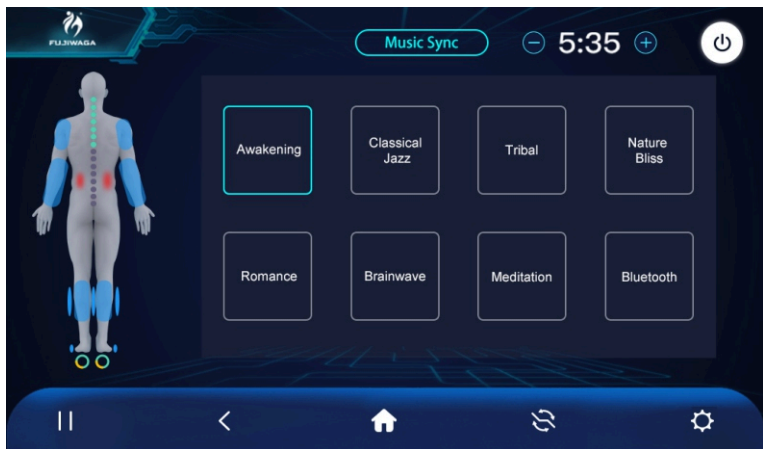

8 Music Sync: Awakening, Classical Jazz, Tribble, Nature Bliss, Romance, Brainwave, Meditation, Bluetooth  
Please note: connect massage chair bluetooth with cellphone to play music

# PRODUCT COMPONENTS

## Main Body Diagram

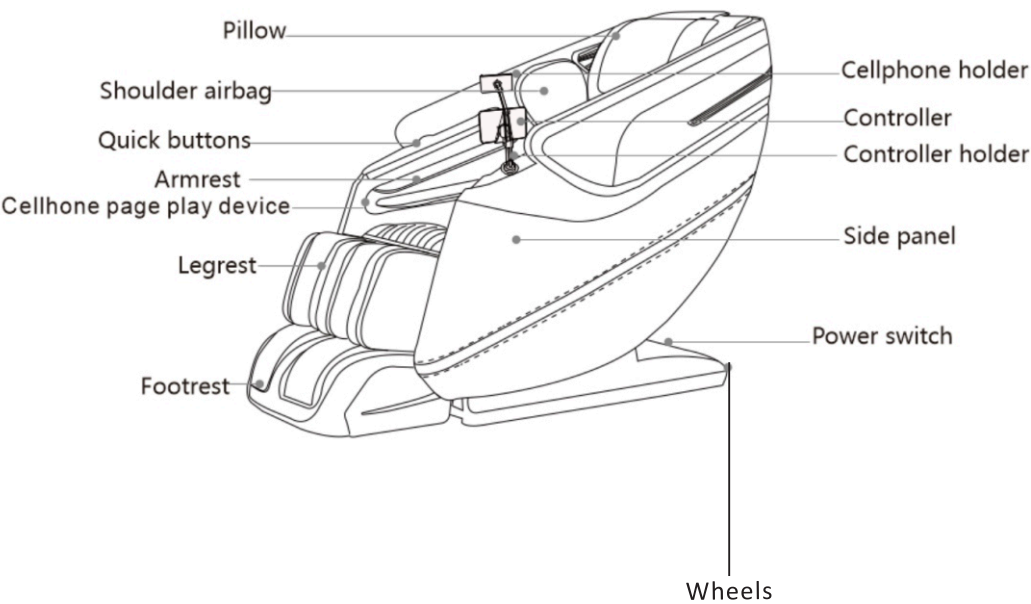

Main Body Diagram

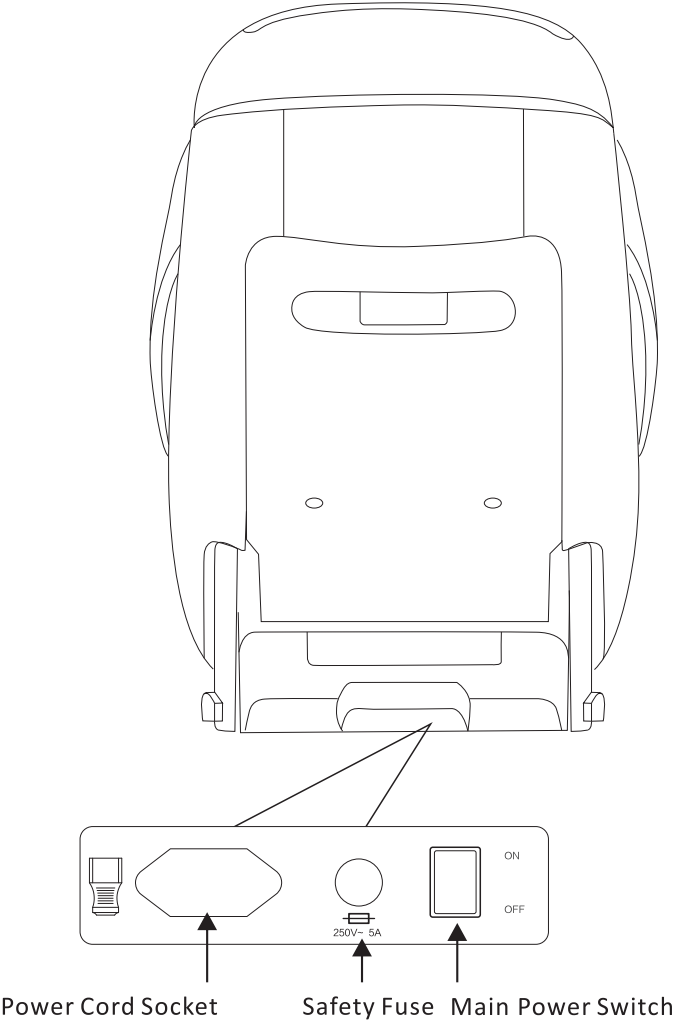

8.Setting



- 1. Language choose: English, Vietnamese
- 2. Massage time: 5Min, 10Min, 20Min, 25Min, 30 Min
- 3. Screen off time: 1Min, 3 Min, 5Min, 8 Min, 10 Min, Never
- 4. Massage Speed: 5 levels
- 5. Air Pressure: 5 Levels
- 6. Speaker Volume: 6 levels
- 7. Sonic Wave 6 Levels
- 8. Ambient Light: ON/OFF
- 9. Bluetooth: ON/OFF
- 10. Heat: ON/OFF

Please note:  
Bluetooth name for cellphone music is "Aquasonic S33"

## CHAIR INSTALLATION

### 3. Place the massage chair in an open area

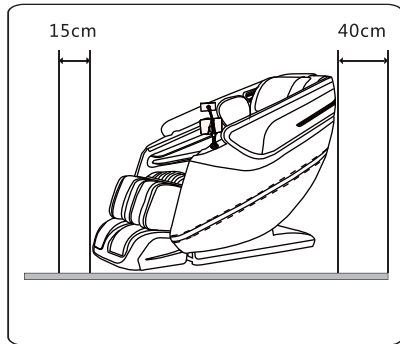

- Allow sufficient space around the chair for recline purposes.  
15cm distance for the back side and 40cm in front of the footrest.

- \*In order to avoid the damage of the floor and to reduce the noise, please put area rug under the massage chair.**
- \*Make sure that there are no barriers in front and the back of the massage chair.**
- \*Please do not put it in wet or uneven floor.**
- \*To avoid signal interference, please place it 4 feet away from AV,TV, and radio.**

### 4. Moving the massage chair

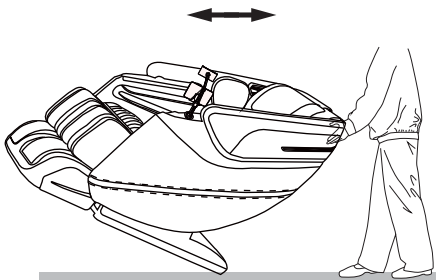

As illustrated, push the backrest downwards and tilt the chair onto its wheels at a 45° angle. Slowly push and maneuver the massage chair to the desired location. Lower the chair slowly and smoothly until it is fully flat on the ground.

#### CAUTION:

- \*Do not move massage chair when occupied or in use.**
- \*Moving the massage chair may cause damage to the floors. Floor protection is recommended (e.g. rugs or carpet).**
- \*Do not drop or suddenly let go of the chair when moving as it may damage the chair.**

## OPERATION GUIDE

### 5. Sonic Wave

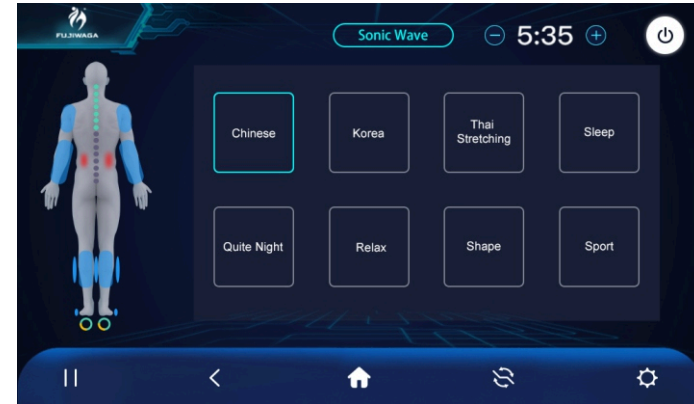

There are 8 Sonic Wave auto programs: Chinese, Korea, Thai Stretching, Sleep, Quite Night, Relax, Shape, Sport



# OPERATION GUIDE

## 4.Manual massage

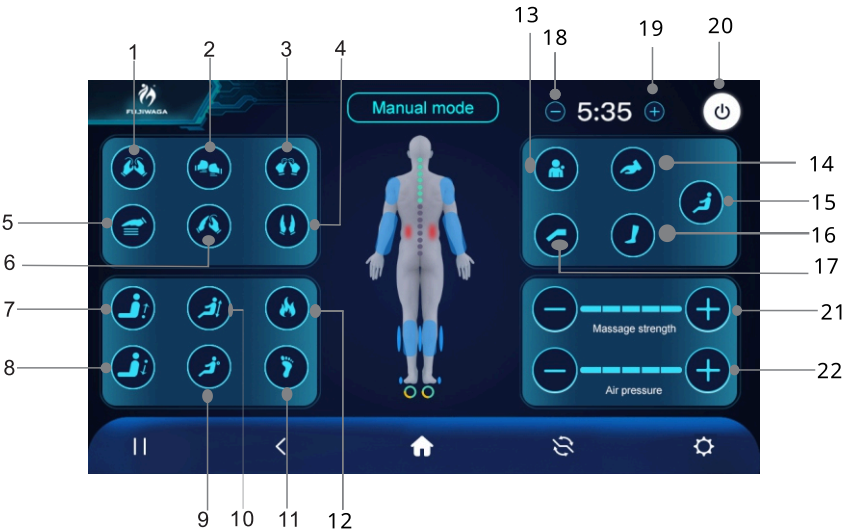

1. Keading 2. Punch 3. Thiatsu 4. Tuina 5. Tap 6. Tap & Knead  
7. Mechanism up 8. Mechanism down 9. Point 10. Area massage  
11. Foot roller 12. Heat 13. Shoulder airbag 14. Arm airbag  
15. Whole body airbag 16. Foot airbag 17. Leg airbag  
18. Massage time reduce 19. Massage time increase 20. Power off  
21. Massage strength adjust 22. Air pressure adjust

# BEFORE USE

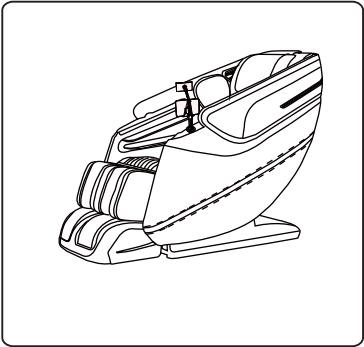

- 1. Make sure the product is in good condition and proper working order.**
- Check the headrest and backrest pad.
  - Inspect the power plug.
  - Make sure the footrest is in its upright original position in order to prevent damage.

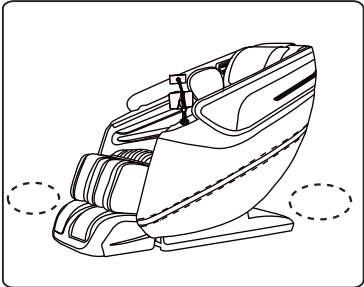

- 2. Check the surrounding environment**
- Ensure there are no people, pets, or objects obstructing the massage chair.

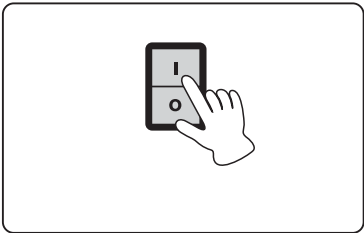

- 3. Plug in the massage chair power cord.**
- Connect the power cord.
  - Turn ON the power switch on the back of the massage chair.

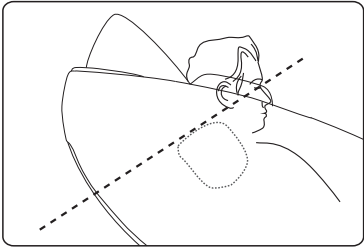

- 4. Adjust the position of the headrest.**
- Adjust the headrest until it is in a comfortable position.

## Shortcut keys



Auto



Heating



Backrest raise



Backrest down



Legrest up



Legrest down



Pause

## Cellphone video page play device

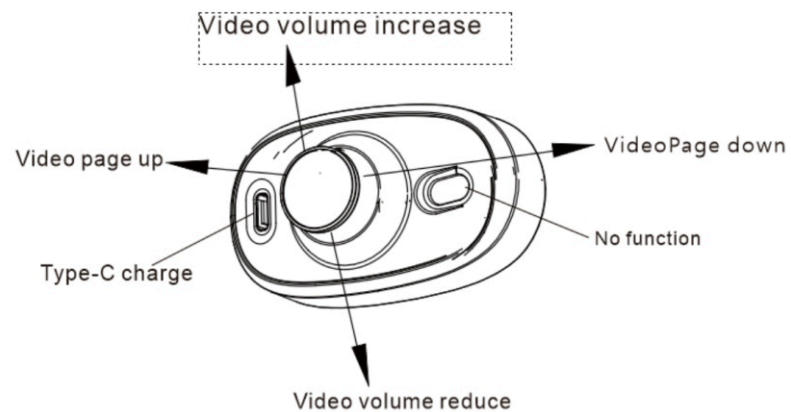

Please note:

To use this function, please connect bluetooth firstly,  
the bluetooth name for this device is "M8888"