

说明书尺寸80x110mm

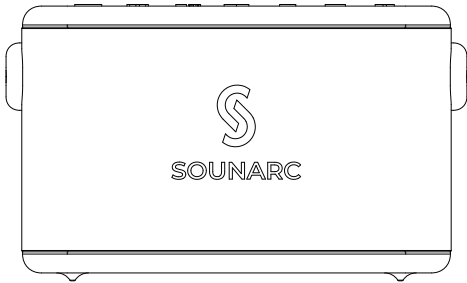

A1
USER MANUAL

Thank you for purchasing the SOUNARC A1 Karaoke Party Speaker. Please read the user manual before use and keep it handy for future reference. If you have any additional questions or comments, please contact us by email at: support@sounarc.com

- Package Contents**
- 1 x SOUNARC A1 Karaoke Party Speaker
 - 1 x Type-C Cable
 - 1 x Carrying Strap
 - 1 x User Manual
 - 1 x Aux-in Cable
 - 1 x Warranty Card
 - 2 x Wireless Karaoke Mics

Specifications

Model	A1
Device Name	SOUNARC A1
Bluetooth Version	5.0
Bluetooth Profiles	A2DP/AVRCP/HFP
Audio Codec	SBC
Transmission Distance	Up to 12m/39ft (open area)
Waterproof	IPX6
Output	80W
Power Supply	DC 5V/2A, via Type-C port
Frequency Range	50Hz – 20kHz
Battery	Speaker: 6000mAh(11.1V/2000mAh) Microphones: 1500mAh
Playtime(Varied by Audio Contents, Light Display & Volume Levels)	Music: 10 Hours(on a 50% volume) Karaoke: 7 Hours(on a 60% volume)
Charging time	Speaker: 2-3 Hours Microphones: 2 Hours

Button Configuration

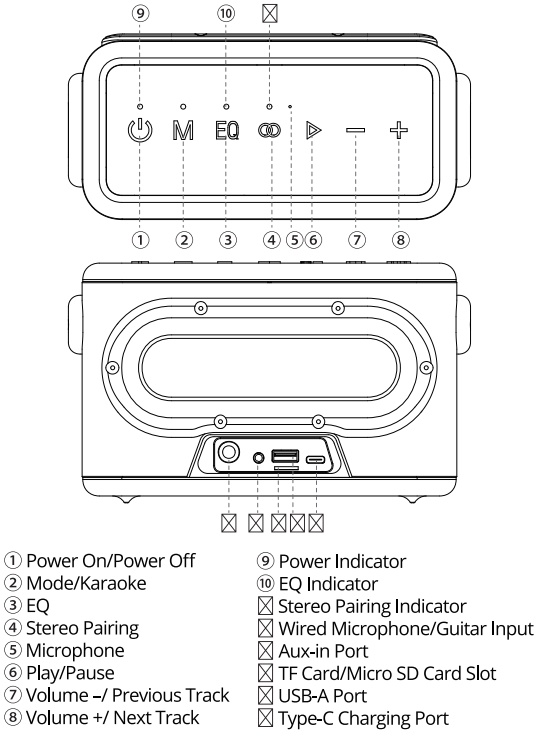

Instructions

Button	Operation	Indicator
Power On/Power Off	Press for 2s to Turn On	Pairing: Power Indicator Flashes Blue Quickly
	Press for 2s to Turn Off	Connected: Power Indicator Stays Blue
	Press Once to Switch Lighting Modes	Indicator Off
	Press for 8s to Forcedly Off	Indicator Off
EQ	Press Once to Enter/Exit Stereo Pairing Mode	
	Press Once to Switch Playing Modes among Bluetooth, TF Card, Aux in & U-disk in Turn	
	Double Press to Enter/Exit Karaoke Mode	
	Press for 2s to Eliminate/Restore Vocal Sound	
M	Press for 3s to Disconnect from Device	
	Press for 8s to Reset	
	Press once to switch EQ Modes among original, 3D, Deep Bass.	Original: Off 3D: Stays White Deep Bass: Stays Green
	Press for 8s to enter/exit power-saving mode to charge for your device	

▶	Press Once to Play/Pause Music under Bluetooth/TF Card/U-Disk Mode	
	Press Once to Mute under Aux-in Mode	
	Press Once to Answer/End a Call	
	Press for 2s to Reject a Call	
-	Double Press to Redial the Last Call	
	Press Once to Turn Down Volume	
	Short Press to Turn Down Mic Volume under Karaoke Mode	
	Long Press to Turn Down Master Volume under Karaoke Mode	
+	Press for 2s to Skip to Previous Track	
	Press Once to Turn Up Volume	
	Short Press to Turn Up Mic Volume under Karaoke Mode	
	Long Press to Turn Up Master Volume under Karaoke Mode	
	Press for 2s to Skip to Next Track	

How to Use

1. Turn On/Off

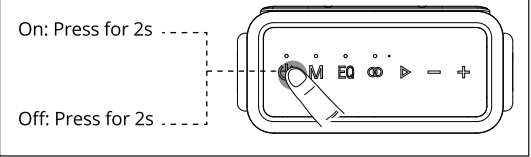

2. Bluetooth Connection
Search & click 'SOUNARC A1' to connect.

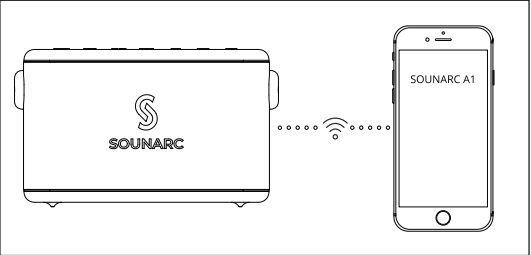

3. Disconnect from Bluetooth
Press the 'Mode' button for 3s to disconnect from Bluetooth.

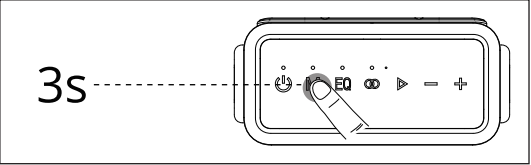

SHENZHEN GEEKBUY E-COMMERCE CO., LTD.
Warehouse 101H, No. 49 Wuhe Avenue, Wuhe Community,
Bantian Street, Longgang District, Shenzhen
Email: support@sounarc.com

UK	REP	Name: APEX CE SPECIALISTS LIMITED Add: 89 Princess Street, Manchester, M1 4HT, UK
EC	REP	AMZLAB GmbH Laubenhof 23,45326 Essen

Model: A1
Made in China

4. USB-A Power Bank Function
This speaker carries a USB charge-out function that will automatically detect your device and begin to charge it when the charging cable is plugged into the USB-A port under powering-on mode.

5. Aux-in Mode
Simply connect the speaker with your non-Bluetooth device via the 3.5 mm audio jack cable.

Note: After plugging in an audio cable, the speaker will automatically switch to Aux-in mode.

6. USB Flash Drive Mode
The speaker will play the music from your U-disk when plugging into the slot.

7. TF/Micro SD Card Slot Mode
The speaker will play the music from your TF/Micro SD card when plugging the card into the slot. The maximum supported memory is 128 GB.

8. Karaoke Mode
Double press 'Mode' button to enter/exit karaoke mode.

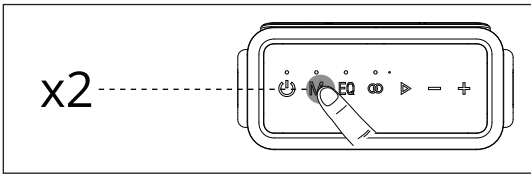

9. True Wireless Stereo Mode
A. Turn on both speakers and make sure they haven't connected with any device.
B. Press 'Stereo Pairing' button once of either speaker to enter stereo pairing mode.
C. If paired successfully, the stereo pairing indicator of both speakers will stay yellow. The Bluetooth indicator of host speaker will flash while the vice one will off.
D. Search & click 'SOUNARC A1' to connect.
E. Press 'Stereo Pairing' button once of either speaker to exit stereo pairing mode.

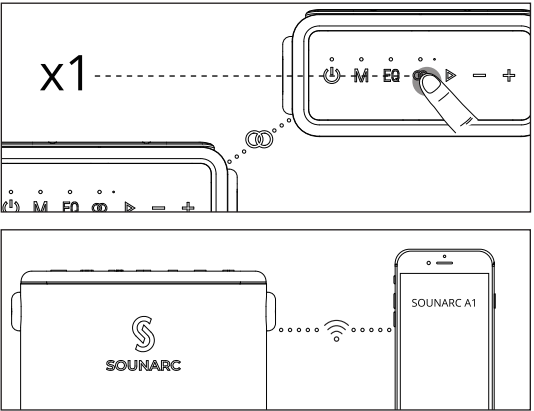

10. Charging

Red Light On	Charging
Goes Off	Charging Completion
Red Light Flashes	Battery Low

11. Reset
Press 'Mode' button for 8s.

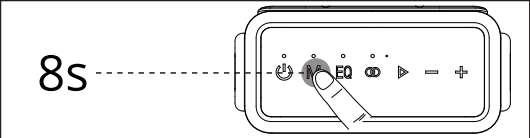

12. Instruction of Wireless Microphone
A. Battery display: 3 layers indicates fully charged; blank means battery low.
B. Red indicator stays on indicates MIC is get fully charged.
C. It is highly suggested that you drain up the battery before charging for the first use.
D. The frequency of 2 MICS are different to avoid the interfere.

13. Auto Power Off
The speaker will power off automatically after 10 minutes if it does not pair with any device through Bluetooth. When in low battery, the speaker will power off automatically as well.

Care & Maintenance

-Do not use any form of detergents or cleaning material to clean the product as any type of chemical may make this device unusable.
-Do not disassemble this product. It contains no user serviceable parts.
-Do not drop or jump on it and treat it with care for the best performance.
-Keep the product in a dry location. Dust, dirt & moisture from humidity can accumulate on the body of the product if kept at an unfriendly place.
-Do not dispose this product in fire or batteries may explode or leak.