



User Manual

DC Fan

DC 팬

FO8E

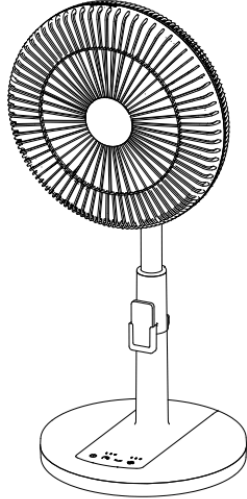

Component Name

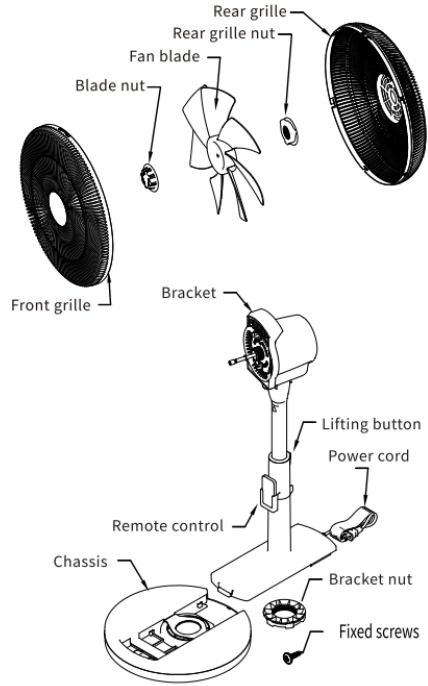

Control Panel

Remote control

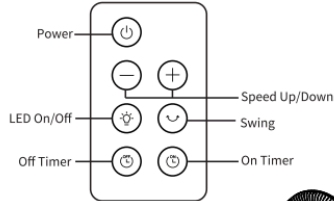

■ How to use the remote control

1. The transmitter part of the remote control shall face the receiver (body). Operation is available at a distance of approx.2 m, within 50° of the left and right sides.
2. Be careful to avoid having objects blocking the signal transmission.



Note

- This product is designed with a preventive device against reverse insertion . If you find that the batteries cannot be fully inserted into the case or the cover cannot be pushed in smoothly,it means that the batteries have the wrong + / - poles, so please reinstall the batteries.
- If the operation indicator on the control panel fails to light up when the remote control is operated, please reinstall new batteries.

Note: ♻️ Please recycle used batteries

Matters Subject to Compliance

- For use of remote controls:
 - Do not use in where it will interfere with the transmission of the signal,e.g. curtains, screens, etc.
 - Where the sun will not shine directly.
 - Away from the fireplace.
- Please avoid throwing, dropping, or immersing the remote control in water.
- Please read this manual carefully before use.

Safety Precautions

Please be sure to comply.

The following instructions are precautions to be observed in order to prevent users from endangering the life and property of others when in use.

- If you disregard the content of the graphics and use them inappropriately, harm or injury may occur,as indicated below.

- Warning** This is labelled as is " envisaged as likely to cause death or serious injury".
- Warning** This is labelled as " may cause injury or damage to the item".

- Please be sure to observe the following graphics and explain them differently (the following graphics are for reference only).

- This symbol indicates a "prohibited".
- This symbol indicates a "mandatory" item that you are required to carry out.

Warning

- Never disassemble, repair, modify the machine or add accessories that are not supplied with this product.
- Make sure the power plug is actually plugged into the outlet.
- This can often lead to fires, or cause fires or electric shocks, and injuries due to improper use.
- Incomplete insertion of the power plug can easily cause a fire due to leakage or overheating.
- Please contact us When repairs are required.

Safety Precautions

Warning

- There are certain specifications for the use of electrical cables and wiring, so do not exceed the limits or use 220V AC.
 - The power cord must not be connected halfway or use an extension cord, and must not share a plug with other electrical appliances, or it may easily cause a fire due to overheating.
- Do not splash or immerse in water.
 - It's easy to cause fire or electric shock due to short circuits.
- Do not turn on the electric fan without the fan blades and front and rear grille installed.
 - This is prone to injury.
- Do not cover the front and rear grilles with foreign objects as this may block the airflow and cause danger or reduce airflow.
- Do not touch the power plug with wet hands.
 - It may cause electric shock.
- Do not damage the power cord and power plug. Do not damage the power cord, work on it, bring it close to an electrically heated product, force it to be twisted, folded pulled, pressed by a heavy object, or tightened.
 - If it is damaged and still forced to use, it may cause electric shock, leakage and fire.
- Please make sure that the fan is disconnected from the power cord before removing the protective shell.
 - Injury or electric shock may be triggered by careless operation.
- Please remove the dust and dirt from the power plug regularly.
 - The power plug may be poorly insulated due to dust or moisture, etc., and cause a fire.
 - Please unplug it from the power supply and wipe it with a dry cloth.
 - Please unplug the power plug unless in use.

-4-

Safety Precautions

Caution

- Do not use in the places listed below.
 - Gas cylinders or the vicinity of fires, places with high humidity, direct sunlight exposure exceeding 40 °C, or areas filled with dust, or areas with igniting gas.
- Please do not blow on your body for a long time.
- Do not use it around obstacles or in unsafe places.
 - It may ignite, explode, or short circuit due to flames, and cause fire or electric shock.
 - It may be harm to health.
 - It may tip over or cause injury.
- Do not insert your fingers into the front, rear grille, or movable parts.
- Do not use diluent (thinner), volatile oil, alcohol, stain remover or alkaline detergent.
 - To avoid damage and deterioration of plastic or painted parts, and accidents such as cuts from fan blades.
- When removing the power plug, make sure that all control switches are turned off and that the power plug is held in your hand. Do not pull the cord.
 - It may cause harm.

Note

- If the power cord is damaged, to avoid danger, it must be replaced by the manufacturer or their maintenance department or similar dedicated personnel. Do not connect a voltage regulator (dimmer) to use this product to avoid danger.
- This machine is not suitable for people with disabilities, perceptual impairments, intellectual disabilities, or those who lack experience and knowledge in mechanical operation (including children).
- Operate on your own, except when a safety officer is present to supervise and provide guidance to assist in operating this machine. Children should be monitored to ensure that they do not play with appliances.

Tips Do not Spray Pesticides or use the product in places where oils or drugs are used, (for prevention of product deterioration or damage).

-5-

Assembly

Bracket Assembly

1. Remove the bracket nut from the lower bracket.
2. Install the body bracket into the chassis.
3. Then tighten the bracket nut from the bottom of the chassis by locking it.

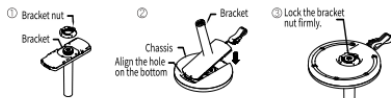

Reminder: To avoid loosening during use, please ensure that the bracket nuts are securely fastened.

Blade Assembly

Please use following combinations in the correct order before use.

- 1 Remove the fan blade nut, motor shaft plastic sleeve, and rear grille nut.



- 2 Put on the rear grille and fasten it with the rear grille nut.

Align the 3 notches of the rear grille with the 3 small posts protruding from the front cover of the motor to tighten the rear grille against the motor. Put the rear grille nut on and lock it to the right (clockwise).



- 3 Install the blade

Insert the fan blade into the motor shaft and tighten it, then fasten it with the blade nut (counterclockwise).

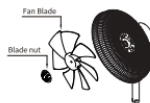

-6-

Assembly

4 Front grille installation

- Align the front grille marker with the left side marker, rotate clockwise to align with the right side marker of the rear grille, and install it on the rear grille buckle.
- Press the front grille and rotate it clockwise to install and position it.
- After assembling the front grille, tighten the fixing screws above the back of the rear grille.

Please note: Please tighten the locking position of each part and complete the assembly so as to avoid the danger of the fan blades flying out due to rotation of the motor.

Height Adjustment

Press the height lifting button to adjust the upper bracket upwards to the appropriate position. When the height needs to be lowered, the upper bracket can be directly pressed down to adjust to the appropriate height.

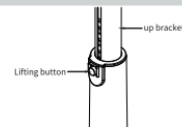

Placement of Remote Control

Attach the remote control holder to the lower bracket.

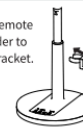

The remote control can be stored in the remote control holder.



-7-

Assembly

Wind Adjustment

In the case of automatic swing or blowing in a head or blowing in a single direction, the blowing direction can be manually adjusted to the desired direction to change the direction of the air.

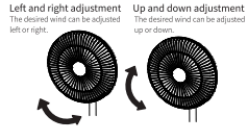

Battery Installation of Remote Control

- ① When the battery is depleted, please remove the old battery and replace it with a new one.
- ② Please use one CR 2025 3V battery with battery specifications; The positive and negative directions of the battery must be consistent with the markings inside the remote control. (As shown in the figure below)
- ③ Please align the transmitter of the remote control with the receiver position of the remote control before implementing the button operation.

Attention: There should be no obstacles between the remote control and the main body, otherwise it will affect operation.

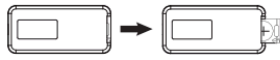

1. Push the small hook in the direction of the arrow.
2. Push on the hook while snapping the slot and pulling it outward.

*The directions of ① and ② need to be applied at the same time.

-8-

How To Use

Control Panel

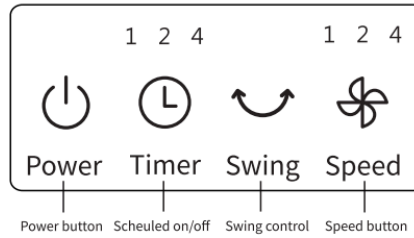

「Power」 button

Press this key to switch the power on or off.

- When the power button is pressed after the plug is connected, the initial operation start with "3-level" wind.

Memory function

- When you press the power button again after the power is turned off, it will start in the same operation mode as before the power is turned off. However, the time of the timer function cannot be memorized.

- Once the power is removed from the unit, all memories will be erased.

※ The unit will automatically shut down after 16 hours of continuous operation without a timer setting.

「Speed」 button

Every time you press the "wind speed" button to increase one level; when it reaches the 7th speed, then the wind will switch to the 1st speed by pressing the wind speed button again, and so on.

- 1 → 2 → 3 → 4 → 5 → 6 → 7 (level)
 ●○○ ○●○ ●●○ ○●● ●●● ●●● ●●●
 Low speed High speed

-9-

How To Use

「Swing」 Button

Each press of the "Swing" button switches between left and right swing or stop.

「Timer」 Button

In shutdown mode

Each time you press this key in the off state, the power-on time will be set in the order shown below (cumulative) and the light will be on.

1 → 2 → 3 → 4 → 5 → 6 → 7 (h) → Light off

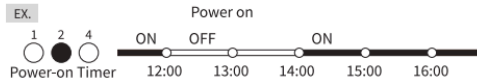

In power on mode

Each time you press this key in the off state, the power-on time will be set in the order shown below (cumulative) and the light will be on.

1 → 2 → 3 → 4 → 5 → 6 → 7 (h) → Light off



Its automatically shuts off when it reaches the set time.

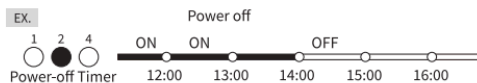

-10-

Troubleshooting

Warning

Turn off and unplug the machine when servicing it. Inadvertent operation may cause injury or electric shock.

Warning

Do not splash water when wiping. This device is susceptible to fire or electric shock due to short circuit.

1. To prevent the risk of electric shock, please unplug the power plug before maintenance.

2. To increase the efficiency and safety of the machine, please regularly maintain and clean the cooling holes of the rear shell. (About once a month).

3. When disassembling, maintaining, or cleaning the front shell, fan blades, and rear mesh, they should be removed in reverse order during assembly.

4. For maintenance of fan blades, body, etc., please use a soft cloth dipped in warm water and neutral cleaning agent to wipe clean, and then dry with a dry cloth.

Caution

Never use volatile complexing agents (gasoline, banana water, etc.), alkaline soapy water, hot water, etc. to wipe the body to avoid damage or deterioration of plastics or painted parts.

5. After wiping the motor shaft clean, please apply lubricant on it prevent rusting and put a plastic sleeve on it, and store it in a place with less moisture.

6. Storage
When not in use, please follow the original assembly steps, disassemble and store in the opposite direction, put it back in the original packaging box, and place it in a dry and cool place.

Specification Values with rated power and 「High」 speed.

Model	Rated voltage (V)	Rated frequency (Hz)	Rated power (W)	Weight (kg)	Blade Diameter (cm)	Energy efficiency (m ³ /min*W)	Size (mm) L * W * H
F08E	220	50	28	3.9	34	2.202	466 x 357 x 809-1007

-11-