

USER MANUAL

TAMMY

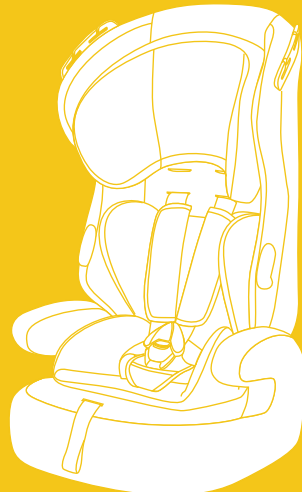

Joyful Kids · Joyful Trip

 www.jovikids.com

 [jovikids_global](https://www.instagram.com/jovikids_global)

 service@jovikids.com

Model PG05
All rights reserved @2024 JOVIKIDS. JOVIKIDS and all associated logos are trademarks.
All product specifications are correct at time of print.
JOVIKIDS reserves the right to change anything at any time without prior notice.
Color representation is as close as processes allow.

Approx.
9^M-12^Y
9-36 KG





EN Scan for user manual

AR يحاشرلإل ایلدلیح لسم

RU сканируйте для руководства пользователя

•

•

•

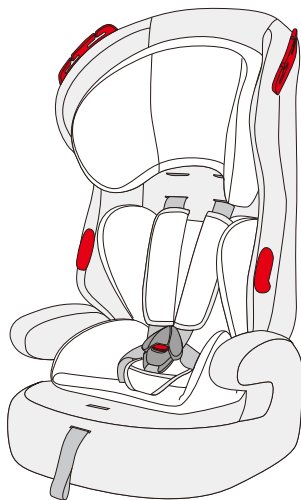

Tammy
PG05

Notice

This booster seat is approved by UN Regulation No.44. It is designed for R44 compatible vehicle seating positions, as indicated by vehicle manufacturers in the vehicle user manual. If you are unsure about compatibility, please consult either the ENHANCED CHILD RESTRAINT SYSTEM manufacturer or your retailer.

Important Safety Notice

DO NOT use this ENHANCED CHILD RESTRAINT SYSTEM in seating positions where an active frontal airbag is installed.

Use In The Vehicle

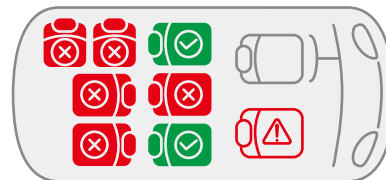

Proper seating positions for your child car seat.



If you need to install the seat in the front passenger seat, please ensure that the airbag is deactivated to avoid serious injury.



WARNING!

Never use this child restraint system in seating positions where an active airbag is installed.



CONTENTS

Content	1
Warning	2
Product Description	3-4
Basic Information	5-6
Installation Method	7-9
Instruction for Weight 9-18kg	7
Instruction for Weight 15-25kg	8
Instruction for Weight 22-36kg	9
Important Safety Precautions	10
Care And Cleaning	11
Warranty	12

WARNING

- 1.The rigid items and plastic parts of the child car seat should be locate and installed so that they are not likely to become trapped by a movable seat or in the vehicle's door during everyday use.
- 2.Any straps securing the restraint to the vehicle should be tight. Straps or impact shields restraining the child should be adjusted to fit the child's body, and straps should not be twisted.
- 3.It is important to ensure that the lap straps are positioned lower than the baby's hips.
- 4.The child car seat should be replaced if it has been subjected to violent stresses in an accident.
- 5.DO NOT leave your child unattended in the baby car seat.
- 6.Secure any luggage or other objects that could cause injuries in the event of a collision.
- 7.DO NOT use the car seat without the fabric cover.
- 8.DO NOT replace the cover of the baby car seat with anything other than the one recommended by the manufacturer, as the cover is an integral part of the restraint system's safety performance.
- 9.Refer to the vehicle manufacturer's handbook for the use of R44.

PRODUCT DESCRIPTION

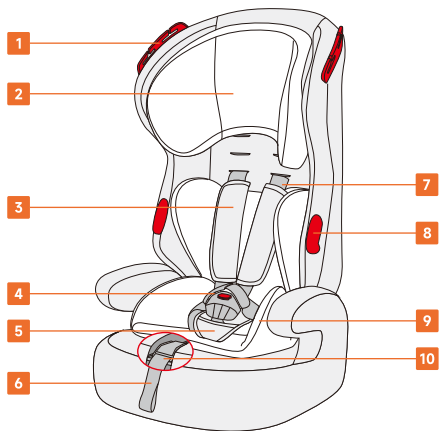

- 1. Upper Belt Guide
- 2. Headrest
- 3. Shoulder Pads
- 4. Buckle
- 5. Crotch Pad
- 6. Harness Adjustment Strap
- 7. Shoulder Straps
- 8. Lower Belt Guide
- 9. Inner Cushion
- 10. Harness Release Button

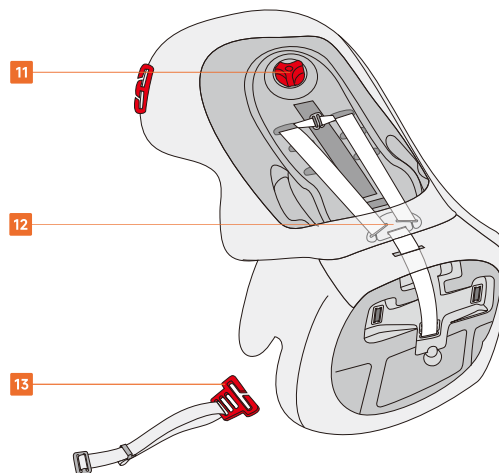

- 11. Headrest Adjuster
- 12. Strap Clip
- 13. Seat Belt Hook (For Group III)

BASIC INFORMATION

Adjustable and Removable Headrest

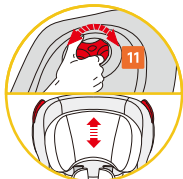

- Turn the headrest adjuster **(11)** to the left/right to the most suitable height.
- Continue turning the headrest adjuster **(11)** to the right until the headrest separates from the seat (Group II+III only).

Removable Backrest



- Firmly push the backrest backward until the booster seat and the backrest are completely separated. (Group III only)

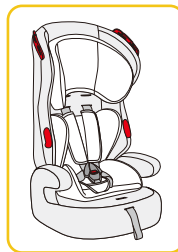

Group I

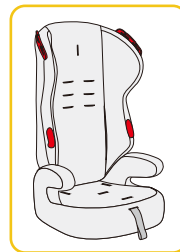

Group II

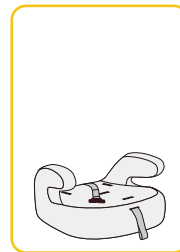

Group III

1. **Group I:** Suitable for children from 9 to 18 kg (approx. 9 months to 4 years).
2. **Group II:** Suitable for children from 15 to 25 kg (approx. 3 to 6 years).
3. **Group III:** Suitable for children from 22 to 36 kg (approx. 6 to 12 years).

INSTALLATION METHOD

Instruction for Weight 9-18kg

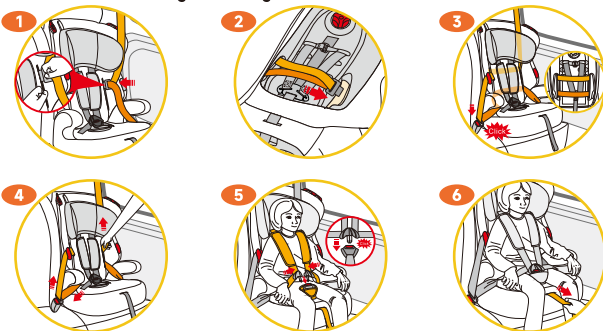

Step 1:

Place the booster seat on the vehicle seat with a 3-point seat belt. Make sure the booster seat is facing towards the front of the car. Guide the seat belt around the side panel of the car seat, ensuring that the lap belt is below the armrest of the seat base.

Step 2:

Insert the lap and shoulder belts into the side slot, loop them around the plastic back panel (above the harness), and then pull them through the slot on the other side.

Step 3:

Pull the belt around the seat and fasten it normally, ensuring the lap section is below the armrest and the diagonal section goes through the lower belt guide (8).

CAUTION! DO NOT twist the seat belt.

Step 4:

To ensure the seat is securely fixed, pull on the top of the shoulder straps (6); there should be minimal or no forward movement.

Step 5:

Guide the two buckle latches together and engage them before inserting them into the buckle (4). Make sure you hear a "click" sound.

Step 6:

Pull the harness adjustment strap (7) until the space between the baby and the straps is about the thickness of your palm.

Instruction for Weight 15-25kg

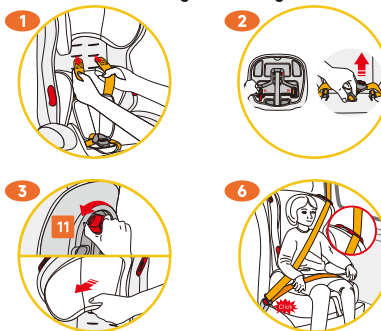

Step 1:

Pull the lap and shoulder belts out from the slot on the opposite side, unloop them from around the plastic back panel (above the harness), and then remove them from the side slot.

Step 2:

Remove the lap and shoulder belts from the slot underneath the seat cushion. Take out the inner cushion (9) after removing the harness belt.

Step 3:

Continue turning the headrest adjuster (11) outward until the headrest separates from the booster seat. Take out the headrest (2).

Step 4:

Thread the seat belt through the upper belt guide (1) and lower belt guide (8) of the booster seat. After ensuring the seat belt is correctly fastened on the booster seat, lock the seat belt until you hear a "click".

INSTALLATION METHOD

Instruction for Weight 22-36kg

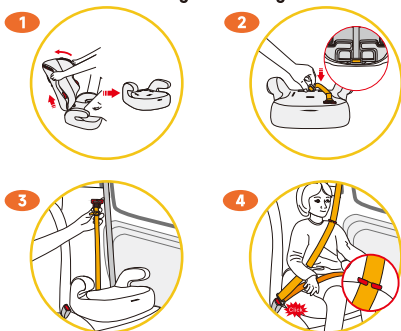

Step 1:

Firmly push the backrest backward until the booster seat and the backrest are completely separated, then remove the backrest.

Step 2:

Insert the seat belt hook (13) into the slot of the booster seat.

Step 3:

Secure the seat belt hook (13) onto the vehicle seat belt.

Step 4:

Thread the seat belt through the thread the seat belt through the upper belt guide (1) and lower belt guide (8) of the booster seat. After ensuring the seat belt is correctly fastened on the booster seat, lock the seat belt until you hear a "click."

IMPORTANT SAFETY PRECAUTIONS



Never leave your child unattended in the child safety seat, especially when not in the vehicle.



For the protection of all vehicle occupants
In the event of an emergency stop or accident, unsecured persons or objects may cause injury to other vehicle occupants.

Always ensure the following:

- The backrests of the vehicle seats are locked (e.g., the foldable rear seat bench latch is engaged).
- All heavy or sharp-edged objects in the vehicle (e.g., on the parcel shelf) are secured.
- All passengers in the vehicle have their seat belts fastened. The child safety seat is always secured when in the vehicle, even if no child is being transported.

To Maintain Optimal Protection

- In the event of a collision at a speed exceeding 10 km/h, the child safety seat may incur damage that is not immediately visible.
- It is important to replace the child seat after such incidents to ensure continued safety. Proper disposal of the damaged seat is required.

CARE AND CLEANING

- Regularly inspect all components for any signs of damage. Verify the proper functioning of all mechanical parts regularly.
- To avoid damage or breakage, ensure the child seat does not become trapped in car doors, seat tracks, or other vehicle mechanisms.
- If the child seat sustains damage (e.g., from being dropped), it must be inspected by the manufacturer for safety assurance.

Care for Harness Buckle

- The functionality of the harness buckle is essential for your child's safety. Malfunctions are typically caused by the buildup of dirt and dust.

Notes for Cleaning the Car Seat

- To maintain the proper functionality of the car seat, please ensure that only original replacement seat covers are used. Replacement seat covers are essential for the correct performance of the car seat and are available from your retailer or authorized branches.



The child seat must not be used without the seat cover.

- The cover can be removed and washed with a mild detergent on the washing machine's delicate cycle (30°C). Follow the instructions on the washing label of the cover. The cover's colors may fade if washed at temperatures higher than 30°C. Do not spin dry, and never use an electric dryer as the fabric may separate from the padding.
- Clean plastic parts with soapy water. Do not use harsh cleaning agents such as solvents.
- The harness can be removed and washed in lukewarm soapy water.

CAUTION! Never remove the buckle tongues from the straps.

WARRANTY

We provide a 3-year warranty for this child car seat against manufacturing or material defects. The warranty period begins on the date of purchase. To validate the warranty, please keep the invoice and register your product on jovkids.com.

The Warranty Does Not Cover:

- Natural signs of wear and damage resulting from excessive stress.
- Damage resulting from inappropriate or improper use.
- Color fastness may diminish when exposed to UV radiation. However, all fabrics fade when exposed to UV radiation. This is not a material defect but a normal sign of wear that is not covered by the warranty.
- Buckle malfunction is often due to the accumulation of dirt and dust, which may prevent it from working properly. If this occurs, please check if you can clean it yourself without damaging the buckle. If cleaning does not resolve the issue, please contact after sales service.

For warranty claims, please contact your retailer directly. They will provide the necessary advice and support. When processing claims, product-specific depreciation rates will be applied. Please refer to our General Terms and Conditions, which are available from your retailer.