

AKASO

# BRAVE 4

A C T I O N   C A M E R A



USER MANUAL

V35AX\_V4.2

# Content

Important Messages	01	>>
Notes on Using the Waterproof Housing	02	>>
What's in the Box	04	>>
Your Brave 4	05	>>
Getting Started	07	>>
Overview of Modes	11	>>
Customizing Your Brave 4	12	>>
Using the Camera's Wifi & AKASO GO App	19	>>
Playing Back Your Content	27	>>
Transferring Your Content	28	>>
Maintaining Your Camera	29	>>
Maximizing Battery Life	29	>>
Adjusting the Zoom Level	29	>>
Battery Storage and Operation	30	>>
Remote	31	>>
Mounting Your Camera	34	>>
Contact Us	35	>>

To get detailed instructions on operating this camera, watch how-to videos by scanning the provided QR code or visiting this link:

<https://www.akasotech.com/video?p=brave4>.



## Important Messages

Congratulations on your new AKASO Brave 4 Action Camera! You must be excited to use your new camera, but please spend some time familiarizing yourself with this manual first so that you get the most out of your camera's features and use it safely. It's important to regularly update the camera's firmware. Connect your camera to the AKASO GO app through the camera's Wifi to download and install the latest firmware.

1. This camera is a precision instrument. Safeguard it from drops or impacts to prevent damage.
2. Store the camera away from devices or objects with strong magnetic fields or power, like motors and magnets.
3. Ensure the camera operates within its recommended temperature range. Avoid leaving it at high or low temperatures for extended periods, as this can reduce its lifespan.
4. This camera body is not waterproof, so install it onto the waterproof housing and make sure all covers are tightly closed before immersing it underwater.
5. After using the camera in saltwater, rinse it with fresh water and gently dry it with a soft cloth.
6. Avoid charging the camera for long periods of time. While charging, keep the camera away from kids and pets to prevent accidents.
7. Remove the battery from the camera if you don't plan to use it for an extended period.
8. Store the camera away from sharp objects and moisture-prone areas.



# Notes on Using the Waterproof Housing

This camera is not waterproof, so it's essential to place it in the included waterproof housing before using it in wet or underwater environments. The housing protects your camera from mud, dirt, debris, and, most importantly, water during your adventures. With the camera properly secured inside, you can safely dive up to 40 meters (132 feet) without concern.

To maximize the potential of the waterproof case, follow these guidelines:

## Before Use

1. Carefully inspect the housing for any signs of wear, cracks, or damage. Replace or repair it immediately if needed to ensure proper protection.
2. Check that all buttons on the housing function correctly and examine the rubber seal for any damage or deformities that could cause leaks.
3. Clean the camera's surface thoroughly to remove dust, dirt, or oil that could compromise the waterproof seal.
4. Once the camera is inside the housing, ensure no foreign objects are trapped around the rubber seal, and firmly close the backdoor to create a secure, watertight seal.

## During Use

1. Avoid prolonged submersion to minimize potential stress on the housing and internal components.
2. Do not exceed the maximum depth rating, as excessive pressure could cause leaks or cracks, endangering your camera.

## After Use

1. Rinse the housing thoroughly with fresh water after each use to remove salt, chlorine, or debris, then dry it completely to prevent stains or residue buildup.
2. Submerge the housing in clean water for 5–10 minutes, gently shaking it to help dislodge any trapped residue.
3. Clean and dry both the interior and exterior with a soft cloth, then leave it in a well-ventilated area to air dry completely before storing it.



**Warm tips:**

1. Before using the housing, perform a waterproof test by submerging it in shallow water to check for leaks.
2. Do not use heat sources such as hair dryers to dry the housing, as excessive heat can compromise its waterproof integrity.
3. Avoid using the housing in hot springs, while bathing, or in extreme weather conditions, as exposure to high temperatures and corrosive elements can shorten its lifespan.
4. If there are sudden temperature or humidity changes, stop using the housing to prevent condensation inside, which could affect image quality.
5. Protect the housing from strong vibrations or impacts, as these may damage the seals and compromise waterproofing.
6. Never attempt to dismantle the housing, as this may impair its waterproof performance.

# What's in the Box



Brave 4  
x 1



Waterproof  
Housing x 1



Battery Charger  
x 1



Battery  
x 2



USB Cable  
x 1



Remote Control  
x 1



Remote Control  
Strap x 1



Buckle Mount  
x 1



Clip  
x 1



Clip 2  
x 1



J-Hook Mount  
x 1



E Mount  
x 1



C Mount  
x 1



D Mount  
x 1



F Mount  
x 1



A Mount  
x 1



Handlebar Clamp  
Mount x 1



Rotation Ball Head  
x 1



Helmet Mount  
x 2



Spanner  
x 1



Bandage  
x 2



Lens Cloth  
x 1



Double-Sided  
Adhesive Tape x 2



Quick Start  
Guide x 1



# Your Brave 4

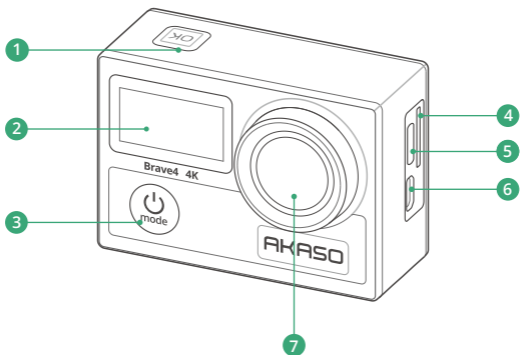

- ① OK / Shutter / Wifi Button
- ② Front Screen
- ③ Power / Mode / Exit Button
- ④ Memory Card Slot
- ⑤ USB / External Mic Port
- ⑥ Micro HDMI Port
- ⑦ Lens



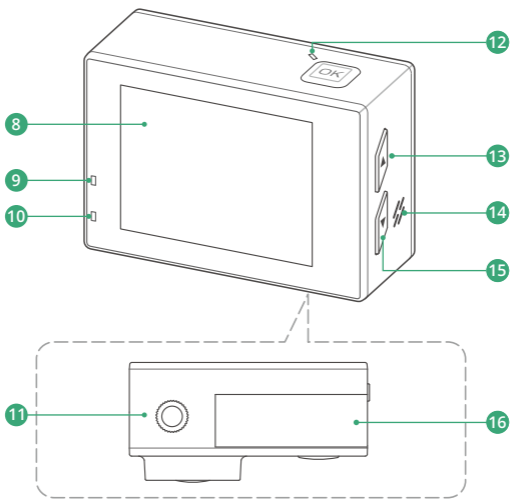

- |                       |                      |                           |
|-----------------------|----------------------|---------------------------|
| 8 Display Screen      | 11 1/4-Inch Nut Hole | 14 Speaker                |
| 9 Working Indicator   | 12 Wifi Indicator    | 15 Down / Playback Button |
| 10 Charging Indicator | 13 Up Button         | 16 Battery Cover          |

**Note:** The camera will not record sounds when it is in the waterproof case.

# Getting Started

Welcome to your AKASO Brave 4. To capture videos and photos, you will need a memory card (sold separately).

## Using memory cards

Use brand name memory cards that meet these requirements:

- U3
- Capacity up to 256GB (FAT32)

### Note:

1. The FAT32 format memory card stops recording when the storage of each file exceeds 4GB and starts to record on a new file.
2. Memory cards larger than the specified maximum capacity can cause issues like non-recognition or even camera malfunctions like unresponsiveness or firmware failure.

## Installing the Memory Card

First locate the memory card slot, then insert the memory card in the direction indicated by the figure. To remove the card, simply press it into the slot with your fingernail, and it will then pop out.

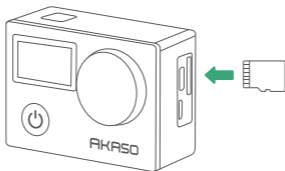

**Note:** Be sure to turn off the camera before installation.



## Formatting the Memory Card

Before using, please format the memory card in the camera. To keep your memory card in good condition, reformat it on a regular basis. Reformatting deletes all of your data, so be sure to transfer your photos and videos first.

1. Press the Mode button several times to enter the camera's settings screen.
2. Press the Down button followed by the OK button to enter the system settings screen.
3. Press the Down button till you find the "Format Card" option.
4. Press the OK button to enter the formatting screen, the screen will show "Format card? Yes/No".
5. Choose the "Yes" option, and press the OK button to confirm formatting.

## Installing the Battery

Push the buckle of the battery cover to open it, then place the battery into its slot and close the battery cover. To remove the battery, pull the battery strip.

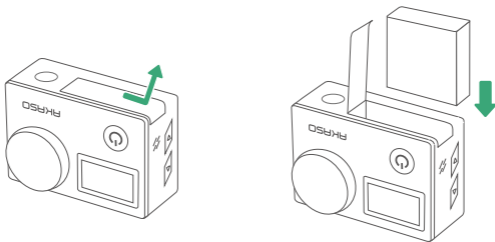

## Charging the Camera

Locate the USB power port, and connect the camera to a USB adapter or computer using the included USB cable. The charging indicator remains red while charging, and blacks out when fully charged. Once fully charged, disconnect the cable.

Tip: Please fully charge the camera before first use; you can also charge the battery separately using the included battery charger; a full charge may take two hours with the camera turned off; you can get up to 90 minutes of runtime in 4K30 with Image Stabilization off and Screen Saver on.

### Powering on or off

**To power on:** Press and hold the Power button for 3 seconds, the camera will beep with the working indicator turning blue. When information appears on the display screen, your camera is on.

**To power off:** Press and hold the Power button for 3 seconds, the camera will beep with the working indicator turning off.

### Turning Wifi on or off

**To turn on:** On the preview screen, press and hold the OK button to turn on Wifi. The camera will enter Wifi mode and display the Wifi information within seconds.

**Tip:** The Wifi indicator will flash yellow when Wifi is turned on, and remain on when Wifi is connected. The camera's Wifi will automatically turn off if not connected to the AKASO GO app within 3 minutes. Re-activate it to reconnect to the app.

**To turn off:** On the Wifi screen, press the OK button to turn off Wifi.

### Switching Modes

**To switch mode:** On the preview screen, press the Mode button to switch modes.

**To exit mode:** Press the Mode button again to exit the current mode.

### Switching Screens

On the preview screen, press and hold the Up button to toggle between front and display screens.

**Note:** The display screen can't be operated when using the front screen.

### Zooming in or out

On the preview screen, press the Up or Down button to zoom in or out. Each press will incrementally zoom in or out by 0.5x. The Brave 4 action camera supports up to 5x zoom.

## Entering the Settings Screen

On the preview screen, press the Mode button several times to enter the camera's settings screen. Press the Mode button again to exit the settings screen.

## Using the Shutter Button

In Photo or Video mode, press the Shutter button to capture photos or start video recording. To stop recording in Video mode, press the Shutter button again.

**Tip:** The working indicator will flash blue while capturing video or photo.

## Entering the Playback Screen

On the preview screen, press and hold the Down button to enter the playback screen. To exit the playback screen, press the Mode button.

# Overview of Modes

The Brave 4 action camera offers 6 modes: Video, Photo, Burst Photo, Time Lapse Photo, Time Lapse Video, and Settings.

## Video Mode

The camera is in Video Mode by default when turned on. In this mode, press the Shutter button to start recording videos. To stop recording, press the Shutter button again.

## Photo Mode

When on the preview screen, press the Mode button to enter Photo Mode. In this mode, press the Shutter button to take a photo at the preset photo resolution.

## Burst Photo Mode

When on the preview screen, press the Mode button twice to enter Burst Photo Mode. In this mode, press the Shutter button to continuously capture photos at the preset shot per second.

## Time Lapse Photo Mode

When on the preview screen, press the Mode button three times to enter Time Lapse Photo Mode. In this mode, when you press the Shutter button, the camera automatically starts the preset countdown to take a photo and repeats this process continuously until you press the Shutter button again.

## Time Lapse Video Mode

When on the preview screen, press the Mode button four times to enter Time Lapse Video Mode. In this mode, when you press the Shutter button, the camera captures a series of frames at the set interval and condenses them into a short video clip.

**Note:** Time lapse video is captured without audio.

## Settings Mode

When on the preview screen, press the Mode button five times to enter the camera's settings screen. On this screen, you're free to configure the video & photo and system settings.



# Customizing Your Brave 4

## Video & Photo Settings

When on the preview screen, press the Mode button five times to enter the camera's settings screen, then press the OK button to enter the video & photo settings screen. You're free to configure the video and photo settings using the Up or Down button.

### 1. Video Resolution

4K 30fps/2.7K 30fps/1080P 120fps/1080P 60fps/1080P 30fps/720P 240fps/ 720P 120fps/720P 60fps/720P 30fps (Default setting: 4K 30fps)

This camera is capable of recording video up to 4K30fps, with higher resolution offering greater clarity and detail due to the increased number of pixels. However, higher resolution video also results in larger file sizes.

**Note:** Capturing high-resolution or -fps videos in low-temperature scenes can consume more power.

### 2. Image Stabilization

Off/On (Default setting: Off)

Electronic Image Stabilization can efficiently smooth out the lens shakes, resulting in smooth and clear videos. This feature is ideal for use in capturing scenes involving activities like riding, skating, and handheld use.

### 3. Loop Recording Time

Off/2 Min/3Min/5Min (Default setting: Off)

Set the loop duration for the camera to capture short video clips. For instance, if you set "Loop Recording Time" to "3 Min", the camera will save video files every 3 minutes. When the memory is full, new video files will overwrite the old ones to ensure continuous recording.

### 4. Time Lapse Interval

1 Sec/2 Sec/5 Sec/10 Sec/30 Sec/1 Min (Default setting: 1 Sec)

Specify the frequency at which the video frames are captured and compiled.



With this setting enabled in Time Lapse Video Mode, the camera captures a series of frames at the set interval and condenses them into a short video clip, making it ideal for use in capturing dynamic or changing scenes, such as clouds, stars, sunsets, and more.

**Note:** Time lapse video is recorded without audio.

## 5. Video Quality

High/Middle/Low (Default setting: High)

Adjust the level of detail in your videos. A higher video quality yields better image quality with more details but results in a large file size.

## 6. Photo Resolution

20MP/16MP/13MP/8MP (Default setting: 20MP)

This camera is capable of capturing 20MP photos, with higher resolution offering greater clarity and detail due to the increased number of pixels. However, higher resolution photos also result in larger file sizes.

## 7. Time Lapse Photo

3 Sec/5 Sec/10 Sec/20 Sec/30 Sec/1 Min (Default setting: 3 Sec)

Set the interval at which the camera takes a photo in Time Lapse Photo mode. For instance, if you select the "3 Sec" option, the camera will start counting down from 3 and take a photo. This process repeats continuously until you press the Shutter button again.

## 8. Burst Photo

3 Shots/5 Shots/10 Shots (Default setting: 3 Shots)

Set the number of photos to be taken per second in Burst Photo mode. Burst Photo can capture up to 10 photos per second, making it perfect for capturing fast-moving activities.

## 9. Continuous Lapse

Off/On (Default setting: Off)

When this setting is enabled in Time Lapse Photo mode, the camera will continuously count down and take a photo until you press the Shutter button again. If disabled, it will count down and take a photo just once.

## 10. Angle

Super Wide/Wide/Medium/Narrow (Default setting: Super Wide)

Adjust the shooting angle. The wide angle captures expansive scenes with a slight trade-off in image quality, while the narrow angle captures the least with intricate detail offered.

## 11. Diving Mode

Off/On (Default setting: Off)

Diving Mode compensates for the blue or green color cast caused by water, ensuring more accurate and natural colors in your underwater footage, so it's ideal for underwater capture.

## 12. Exposure Value

-2/-1/0/1/2 (Default setting: 0)

EV (Exposure Value) lets you adjust the brightness of your photos and videos. A higher EV value creates a brighter image, while a lower value results in a darker image.

## 13. WDR

Off/On (Default setting: Off)

WDR (Wide Dynamic Range) can enhance details in both dark and bright areas of an image, especially in high-contrast scenes.

## 14. Date Stamp

Off/Date/Date&Time (Default setting: Date&Time)

With this setting enabled, the camera will add a watermark to the video or photo based on your settings. For example, if the "Date & Time" option is enabled, the current date and time will be stamped on your video or photo.

## 15. Motion Detection

Off/On (Default setting: Off)

When this setting is enabled, the camera automatically starts recording video upon detecting movement. It continues recording until no motion is detected for 15

seconds or until you manually pause it.

**Tip:** Pressing the OK button during recording stops the video and saves the file. This also disables the setting. To use this feature again, re-enable it in the system settings.

## 16. Meter

Center/Average/Spot (Default setting: Average)

Select a suitable mode based on the scenario to optimize your shots.

## 17. Sharpness

Strong/Normal/Soft (Default setting: Normal)

Adjust the sharpness of your scene's elements to capture fine details, thereby enhancing the overall image or video quality.

## 18. ISO

Auto/100/200/400/800/1600/3200 (Default setting: Auto)

ISO controls the image sensor's sensitivity to light. A higher ISO increases sensitivity, making it valuable in dimly lit conditions, though it may introduce graininess. A lower ISO is ideal for bright conditions, producing clearer images with reduced noise.

# System Settings

When on the preview screen, press the Mode button five times to enter the camera's settings screen, then press the Down button followed by the OK button to enter the system settings screen. You're free to configure the system settings by using the Up or Down button.

## 1. Filter

Normal/Black&White/Sepia/Negative/Warm/Cold/Red/Green/Blue (Default setting: Normal)

Choose a desired filter to make your shots more captivating.

## 2. White Balance

Auto/Daylight/Cloudy/Tungsten/Fluorescent (Default setting: Auto)

White Balance fine-tunes the color temperature of your videos and photos, ensuring optimal color accuracy in both warm and cool lighting conditions.

## 3. Microphone

Built-in/External (Default setting: Built-in)

Choose to select either a built-in microphone or an external one. To use an external microphone for better sound quality, select the "External" option first. Then, connect a compatible external microphone to the camera's USB port.

**Tip:** If you do not wish to use an external microphone, be sure to select the "Built-in" in case the camera does not properly record sound during video recording.

## 4. Power Frequency

50Hz/60Hz/Auto (Default setting: 60Hz)

Select the frequency for which the video recorded or played back on the TV according to your region. If you live in the northeastern area, please set the power frequency to 60Hz. If you live outside this area, set it to 50Hz. Be sure to select the correct format to avoid the light waves while capturing indoors.

## 5. Language

English/简体中文/繁体中文/Italiano/Español/Deutsch/Français/日本語/한국어  
(Default setting: English)

Set the desired system language for your camera interface.

## 6. Date & Time

YYYY/MM/DD, MM/DD/YYYY, DD/MM/YYYY (Default setting: MM/DD/YYYY)

Manually set your camera's date and time. The camera's date and time will sync with your phone when it's connected to the AKASO GO app.

**Note:** The date and time will be automatically reset when the battery is removed from the camera.

## 7. Sounds

**Shutter:** On/Off

**Beep:** On/Off

**Boot:** On/Off (Default setting: On)

**Volume:** Low/Medium/High (Default setting: Medium)

You can turn the shutter, beep, and boot-up sounds on or off or adjust the camera's system volume.

## 8. Driving Mode

Off/On (Default setting: Off)

When the camera is connected to a power source with this feature enabled in Video Mode, it will automatically power on and start recording. Upon disconnection from power, the camera will shut down and save the recorded footage. If the SD card reaches full capacity, the camera will automatically delete the oldest recordings to maintain continuous recording.

**Note:** This feature is only available in Video Mode; to ensure proper functionality, avoid using the camera in environments exceeding 45°C, such as inside a vehicle without air conditioning during summer.

## 9. Upside Down

Off/On (Default setting: Off)

This setting determines the orientation of your videos or photos to help you prevent upside down footage.

**Note:** With this feature enabled, the user interface will be upside-down.

## 10. Screen Saver

Off/30 Sec/1 Min/2 Min (Default setting: 1Min)

Determine when the camera's display should go dormant to conserve battery. If you need the screen back on, just tap it or press any button.

## 11. Auto Power Off

Off/3 Min/5 Min/10 Min (Default setting: 5 Min)

Set the duration of inactivity after which the camera automatically powers off. If not operated within the chosen duration, the camera will shut down.

## 12. Format Card

Cancel/Confirm (Default setting: Cancel)

Format your memory card before using it for better compatibility. To keep your memory card in good condition, reformat it on a regular basis. Formatting will delete all the media files stored in the memory card. Ensure important files are saved elsewhere before proceeding.

## 13. Reset

Confirm/Cancel (Default setting: Cancel)

This option resets all settings to their default values.

## 14. About

Brand: AKASO

Model: Brave 4

Version: AX-\*\*\*\*\*-V\*.\*

Check the camera's brand, model, and version.

# Using the Camera's Wifi & AKASO GO App

## (1) Features of the Camera's Wifi

The camera Wifi works to connect the camera to the AKASO GO app to preview or transfer files.

**Note:** The camera's Wifi will not be connected to the internet. Disconnect it to restore internet access.

## (2) Features of the AKASO GO App

- ① View the camera's status on your phone.
- ② Remotely control the camera with your phone.
- ③ Preview videos and photos stored on the SD card.
- ④ Download or edit videos or photos captured by your camera.
- ⑤ Update the camera's firmware.

### Tips:

- ① Ensure the camera's Wifi is active before connecting to the AKASO GO app.
- ② The camera cannot be operated in Wifi mode. Exiting the Wifi screen disconnects the camera Wifi automatically.

## (3) Downloading the AKASO GO App

- ① To sync your camera with the app, download the AKASO GO app from the App Store (iOS) or Google Play (Android) by searching for "AKASO GO". Alternatively, use the provided QR code:



AKASO GO



Android



iOS

- ② Access all app features by registering and logging into your AKASO GO account.



## (4) Creating An Account for the AKASO GO App

- ① Open the AKASO GO app, then tap “My” in the bottom right corner to enter the registration page.

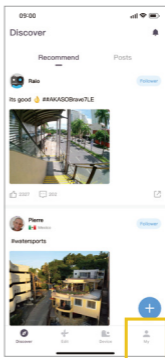

- ② Tap “Join Now” to enter the required information for login, then tap the “Log in” option. Now you successfully create the app account.

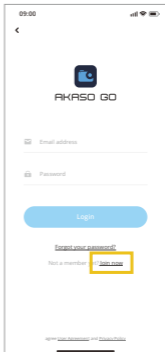

## (5) Connecting to the AKASO GO App via Wifi

Please follow the steps below to connect your camera to the AKASO GO app.

**Note:** For a successful connection, first allow the app to access your Location and Local Network.

**Step 1:** Turn on your camera, press and hold the OK button to turn on Wifi.

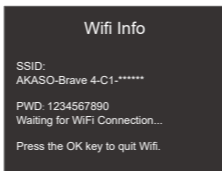

**Step 2:** Enter your phone's Wifi settings page, find the camera's Wifi named "AKASO-Brave 4-C1-\*\*\*\*\*" in the list and tap on it, then enter the password 1234567890 to connect the device's Wifi.

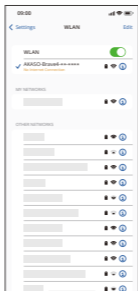

**Step 3:** Open the AKASO GO app, tap "Device"—>" Add Device", then select "Brave4" from the list to establish a connection.

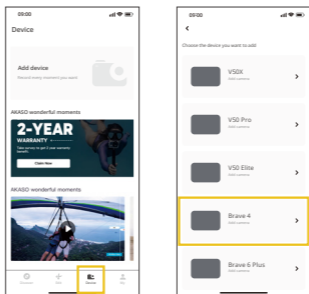

**Step 4:** Tick "The above operation has been confirmed", and tap "Live Preview". Your camera will be connected to the AKASO GO app in seconds.

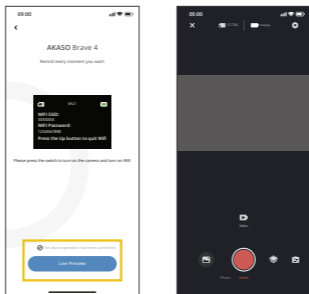

## Tips:

- ① If you failed to connect the camera's Wifi, please make sure you successfully turned on the camera's Wifi. Please tap the "Research" option if you can't find the camera's Wifi.
- ② While connecting the camera's Wifi, a "No Internet Connection" or "Weak Security" notification will appear since the phone's data is paused.
- ③ The screenshots and steps above are for your reference only.

## (6) AKASO GO App Introduction

### A. User Interface

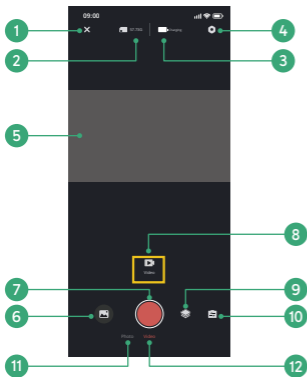

- ① Disconnect from the app
- ② Remaining Card Capacity
- ③ Battery Status
- ④ System Settings
- ⑤ Live Feed
- ⑥ Album Access
- ⑦ Shutter
- ⑧ Modes Available
- ⑨ Video/Photo Settings
- ⑩ Angle Settings
- ⑪ Photo Modes
- ⑫ Video Modes

## B. Album

### ① Accessing the Album

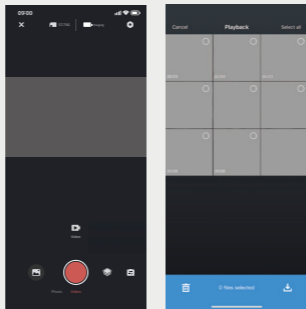

**Step 1:** Tap the “Album” icon in the bottom left corner to view videos and photos stored on the SD card.

**Step 2:** Once inside, swipe up to see all files. Select any file to play it.

**Tip:** To access files captured by the camera, first allow the app to access your phone's album in Settings → AKASO GO → Photos → All Photos.

### ② Downloading Files to Your Phone

You can download video or photo files stored in the memory card via the AKASO GO app.

Follow the steps below to download files from the app to your phone.

**Step 1:** Access the album and tap the “Select” icon in the upper right corner.

**Step 2:** Select the file you want to download.

**Step 3:** Tap the “Download” icon in the bottom right corner and confirm the download.

**Step 4:** The file will be saved to your phone's gallery once the download completes.

**Note:** Do not alter Wifi settings or disconnect from the app during download.

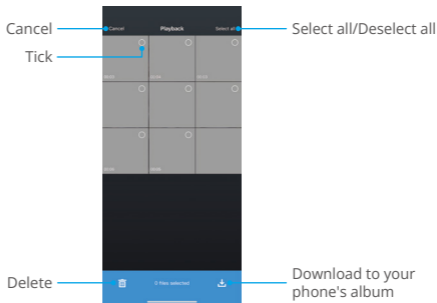

### ③ Delete Files on the App

Follow the steps below to delete files on the app.

**Step 1:** Access the album and tap the "Select" icon in the upper right corner.

**Step 2:** Select the file you want to delete.

**Step 3:** Tap the "Delete" icon in the bottom left corner and confirm the deletion.

**Step 4:** The selected file is now deleted.

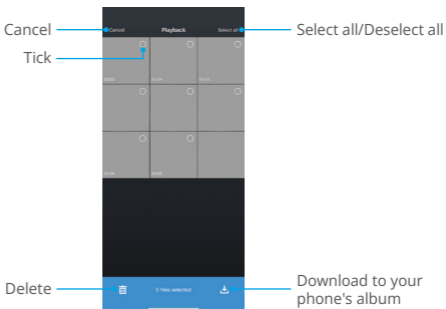

**Note:** Do not alter Wifi settings or disconnect from the app during deletion.

## C. System Settings

### Accessing System Settings Screen

Tap the Settings icon  in the upper right corner to access the AKASO GO app's settings screen.

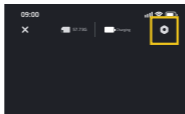

### System Settings Menu

You can configure photo, video, and system settings within the System Settings screen. For more details about these settings, please refer to sections **Video & Photo Settings** and **System Settings**.

# Playing Back Your Content

You can play back your contents on the camera, your computer, TV, or smartphone. To play back your videos and photos on a computer, you need to transfer these files first. Transferring files also frees up space on your memory for new contents. With this method, the playback resolution depends on the resolution of the device and its ability to play back that resolution.

## Viewing Videos and Photos on Your Brave 4

1. Turn on the camera.
2. Press and hold the Down button to enter the playback screen. **Note:** If your memory card contains a lot of content, it might take a minute to load.
3. When on the playback screen, press the Up or Down button followed by the OK button to enter the video or photo set.
4. Press the Down or Up button to select a video or photo file you want to play.
5. Press the OK button to play the selected file. **Tip:** To delete the file, press and hold the OK button, and choose the "Yes" option, the selected file will be deleted.
6. To exit the playback screen, press the Mode button.



# Data Transmission

To playback or edit your files on the computer, you will need to first transfer them. You can transfer them in the following two methods.

## Method 1: Transferring files via a card reader.

- ① Ensure the camera is turned off, then carefully remove the SD card
- ② Insert the SD card into a card reader.
- ③ Connect the card reader to your computer's USB port.
- ④ Copy files to your computer for playback or editing.

## Method 2: Transferring files via a data cable.

- ① Connect your camera to the computer using a USB data cable.
- ② When prompted, select "USB Storage" as your connection preference. You'll be notified that your camera is now connected to the computer.
- ③ Navigate to the memory card drive on your computer, then transfer files as desired for playback or editing.

**Note:** Ensure you're using a USB data cable, not just a charging cable, to enable data transfer.



## Maintaining Your Camera

Follow these guidelines to get the best performance from your camera:

1. For the best audio performance, shake the camera or blow on the mic to remove debris from the microphone holes.
2. To clean the lens, wipe it with a soft, lint-free cloth. Do not insert foreign objects around the lens.
3. Don't touch the lens with fingers.
4. Keep the camera away from high temperatures and direct sunlight to prevent damage.

## Maximizing Battery Life

If the battery reaches 0% while recording, the camera saves the file and powers off. To maximize battery life, follow these guidelines when possible:

- Turn off Wireless Connections.
- Capture videos at lower frame rates and resolutions.
- Use the Screen Saver setting.

## Adjusting the Zoom Level

The Zoom function lets you magnify distant subjects or widen the scene for immersive first-person shots, giving you more flexibility in capturing your shots. This feature is available for all the shooting modes. When on the preview screen, press the Up or Down button to zoom in or out.



## Battery Storage and Operation

1. If storing for extended periods, maintain a battery charge of 50-60%. Charge every 3 months and discharge the battery every 6 months.
2. Do not store the battery with metal objects such as coins, keys, or necklaces. If the battery terminals come close to metal objects, a short circuit may cause fire.
3. Store the battery in dry areas, safe from potential physical damage caused by squeezing or collision.
4. Avoid using or storing the battery at high temperatures, such as in direct sunlight or a hot compartment. The battery will heat up, malfunction, or have its service life shortened in these conditions.
5. Avoid using or storing the battery in low-temperature environments, as this will shorten the battery life or cause it to malfunction.
6. Avoid environments with strong static or magnetic fields; these can compromise the battery's protective unit, posing safety risks.
7. If the battery emits an odor, overheats, changes color, gets distorted, or exhibits any anomalies, discontinue use and remove it immediately from the camera or the battery charger whether it is being used, charged, or stored.
8. Safely insulate used electrodes to prevent potential hazards.



# Remote

When the camera is turned on, it will be automatically connected to the remote within 10 meters of distance. You can control the camera to take photos or record videos using the remote.

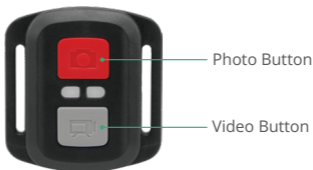

**Note:** The remote is splashproof only.

## Video

To record video, first make sure the camera is in Video mode, then press the Video button. The camera's working indicator will be flashing during video recording. To stop recording, press the Video button again.

## Photo

To capture a photo, first make sure the camera is in Photo mode, then press the Photo button. The camera will emit a shutter sound indicating the completion of the shot.

## Burst Photo

To capture burst photos, first verify the camera is in Burst Photo mode, then press the Photo button. The camera will emit a shutter sound indicating the completion of the shot.

## Time Lapse

To capture time lapse photos or videos, first verify the camera is in Time Lapse mode, then press the Photo or Video button.



## Replacing the CR2032 battery of the remote

1. Use a screwdriver to remove the 4 screws on the back cover of the remote, allowing you to open it.



2. Remove another 4 screws on the remote's circuit board.



3. Lift the circuit board and slide out the battery, as shown below.

**Note:** Avoid rotating the circuit board to prevent reversing the remote control buttons.



4. Install the new battery, keeping the "+" pole facing up.
5. Install all 4 screws back onto the circuit board.



6. Install all 4 screws back into the cover.

## Mounting Your Camera

Enhance your user experience by mounting the camera to various gear like helmets and more. Here's a quick guide.

**Note:** If you plan diving with the Brave 4 action camera, install it onto the waterproof housing to prevent it from getting soaked.

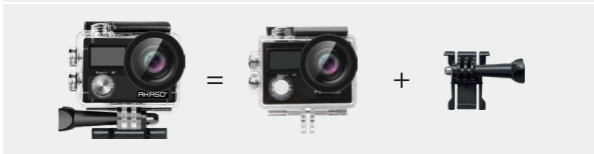

Mount the camera onto a helmet.

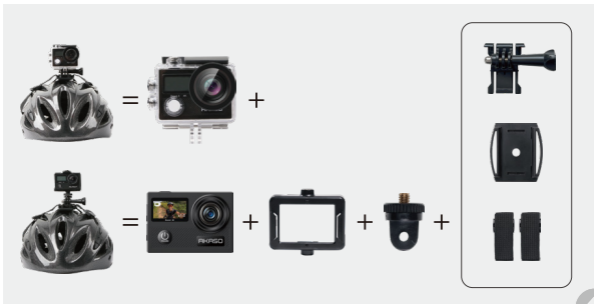



Mount the camera onto a handlebar.

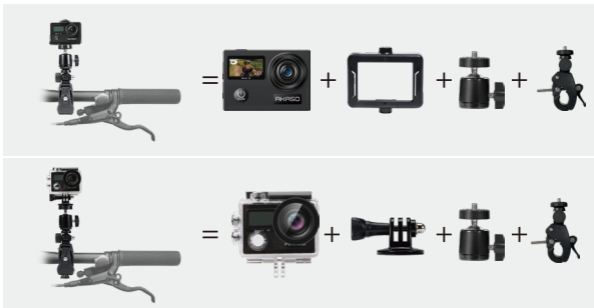

## Contact Us

☎ (888) 466-9222 (US)    ✉ [cs@akasotech.com](mailto:cs@akasotech.com)    🌐 [www.akasotech.com](http://www.akasotech.com)

For any inquiries about AKASO products, please feel free to contact us.

We will respond within 24 hours.

